

## RAC

Indoor Unit: C S - S 18 N K U -1  
Outdoor Unit: C U - S 18 N K U -1  
Set: S 18 N K U -1

1	2	3	4	5	6	7	8	9
Series	ModelType	Connection configuration	Function	Capacity	Development	Category (Type)	Voltage	Others
C: Residential	S: Indoor unit U: Outdoor unit	X: Deluxe type K/None: Internal purpose MK: Indoor unit for Multi zone Connected Type(Multi-zone)Numerical: Numerical+K	S: Cooling only E: Heat pump	Cooling Capacity in BTU/h	Development Series No.	K: Wall Mount B4: Mini Ceiling Recessed K: Internal	U: 208/230V, 60Hz 1: 115V, 60Hz	-1: Non-Low Ambient W: Multi/Single Zone common use -1: Non-Low Ambient

## PAC

Indoor Unit: S - 26 P U 1 U6  
Outdoor Unit: U - 36 P S 1 U6  
Set: 26 P S 1 U6

1	2	3	4	5	6
ModelType	Capacity	Series	Category(Function)	Development	Voltage
S: Indoor unit U: Outdoor Unit	Cooling Capacity in BTU/h	P: Large Capacity series	K: Wall Mount U: Ceiling Recessed T: Ceiling suspended F: Concealed Duct S: Cooling Only H: Heat Pump	Development Series	U6: 208/230V 60Hz



Use of the AHRI Certified™ mark indicates a manufacturer's participation in the certification program. For verification of certification for individual products, go to www.ahridirectory.org

Certified to ISO 9001:2008  
Panasonic HA Air-Conditioning (M) Sdn.Bhd.  
Cert. No.: MYAR 1010

Certified to ISO 14001:2004  
Panasonic HA Air-Conditioning (M) Sdn.Bhd.  
Cert. No.: MYER 0112



# Panasonic®

Panasonic Corporation of North America  
Panasonic Appliances Air-Conditioning North America  
Two Riverfront Plaza, Newark, NJ 07102-5490 U.S.A.  
us.panasonic.com/aircon

Panasonic Canada Inc.  
Enterprise Product Sales  
5770 Ambler Dr., Mississauga, ON, L4W 2T3 CANADA  
www.panasonic.ca

# AIR CONDITIONING and HEAT PUMP PRODUCTS

## INVERTER



Because its products are subject to continuous improvements, Panasonic reserves the right to modify product design and specifications without notice and without incurring any obligations.  
©Copyright 2012, Panasonic Air Conditioning Products.



Caution Related to Safety

Do not add or replace refrigerant other than the specified type. Manufacturer is not responsible for the damage and deterioration in safety due to usage of other refrigerant.



# The History of Panasonic Air Conditioning

The Panasonic Air Conditioning Group has grown into a global company through its continuous quest for product innovations and technology. The group has evolved from manufacturing compressors to providing comprehensive air conditioning solutions. This has earned Panasonic, the reputation as the most trusted brand for superior energy-efficiency and reliable products.

- 1958 Started production and sales of Home Coolers  
The Electrical Appliance Business Group (Kadoma) started cooler production in March 1958. Started sales in May under the "Home Cooler" name.
- 1961 Started exports of Home Coolers
- 1965 Launched Room Coolers
- 1968 Began development of Rotary Compressors  
Later, their high efficiency and high quality attracted domestic and overseas air conditioner manufactures. Began external sales.
- 1972 Established overseas business base in Malaysia  
MAICO was established in Malaysia as the Aircon Group's first overseas base. From this time, MAICO started to export to Japan, Indonesia, Australia, and other markets. Panasonic started operating a twin-base system with a presence in Japan and Malaysia.
- 1983 Launched inverter Air Conditioner  
Started sales of Panasonic's first inverter air conditioners and has since gained increasing popularity. Inverter became the future technology of air conditioner market.  
Launched Ductless Air Conditioners to USA
- 1985 Began development of Scroll Compressors  
Began development of scroll compressors, offering high efficiency, low noise, and low vibration in comparison to rotary compressors.
- 1989 Introduced Simultaneous Heat & Cool VRF
- 1990 Launched world's first Compact Scroll Compressor-equipped Air Conditioner
- 1992 Developed industry's smallest outdoor air conditioning unit: "Chi-size"
- 1993 Established Matsushita-Wanbao (Guangzhou) Air Conditioner (MWAC)  
Established Matsushita-Wanbao (Guangzhou) Compressor (MWCC)  
Established Matsushita Air Conditioner Engineering (Matsushita ACE)
- 1995 Started the export of VRF



- 1998 Introduced GAS Heater Air Conditioner 14KGS11
- 2001 Introduced first VRF "ECO-Multi" to USA
- 2003 Launched first R410a refrigerant Ductless A/C to USA  
Launched EcoCute as a result of better energy-saving technology  
Launched accumulator-less, high-efficiency, CO<sub>2</sub> scroll compressor for EcoCute  
Began production of Multi-split packaged air conditioner (mini-VRF)
- 2005 Launched air conditioner automatic filter cleaning function (AC robot)  
Product became extremely successful in the Japanese market. Since then, Panasonic launched a series of innovative products such as airstream robots and motion sensors which significantly improved Panasonic's air conditioner market share.
- 2006 Renewed ECO-Multi to ECO-i. revised the line-up to inverter driven  
Aggregated global production of Panasonic compressors reached 200 million units
- 2008 In 2008 Energy Conservation Grand Prizes, EcoCute won its first Director General Prize of Agency of Natural Resources and Energy, while Panasonic air conditioner won the Chairman Prize of the Energy Conservation Center of Japan Started Air to Water heat pump business in Europe
- 2009 Established air conditioner dedicated sales company in Europe (PHAAE)  
Panasonic HA Air-Conditioning Europe (PHAAE) strengthened the commercial air conditioning business.
- 2011 Integration of Sanyo HVAC USA into Panasonic Corporation of North America.
- 2013 Celebrating the 30th anniversary of marketing in the USA.  
Serving the US Ductless market since 1983
- 2014 SYSTEM 5 and Wireless Communication



## Technological Milestones

### 1998 Introduced revolutionary Gas Heater Air Conditioner 14KGS11.

That maintains a consistent heating performance level, regardless of how much the ambient temperature goes down outside.

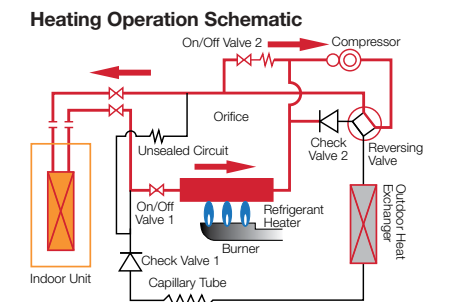

### 2001 Launched VRF "Eco-Multi" to the US market.

Eco-Multi was displayed at the AHR show, and was introduced to other ductless manufacturers. It's the new individual air-conditioning system that effectively combines a power control compressor and an electronic refrigerant control valve.

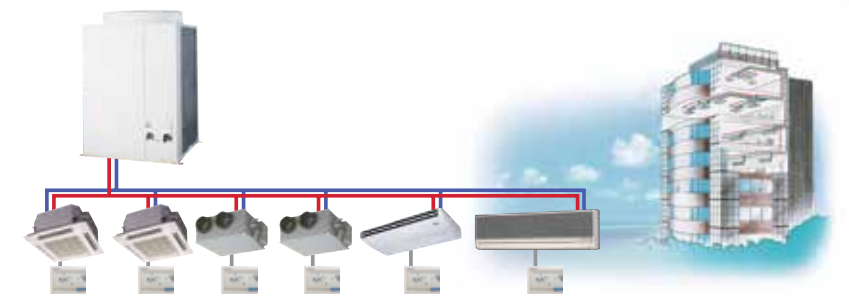

### 2003 First R410a driven ductless model, 24KS62R, was introduced.

Again, blazed a trail to other ductless manufacturers.



### 2013 Introduce EXTERIOS series to US market

SEER 28.5 Highest Efficient model in Industry as of 2013/March



# Air Conditioners and Heat Pumps Line-Up

## Panasonic: Your Best Choice in Mini Split Air Conditioning and Heat Pump Systems

\*Please refer to the model identification on the back of this catalog.

Since 1983, Panasonic's Mini Split Air Conditioner and Heat Pump products offer a wide range of versatile solutions for cooling and heating requirements for single or multiple rooms. The indoor unit (evaporator) is mounted inside a room and it is connected to the outdoor unit (condenser) via refrigerant lines and inter-unit wiring through a 3-1/2" opening in the wall. Since no ductwork is required, installation is simple, fast and efficient. Ducted models are also available. The indoor unit has been uniquely designed to provide whisper quiet operation while delivering comfort throughout the room (s). Panasonic Mini Split Systems are stylish and offer whisper-quiet operations, quality and reliability you can count on.

### HEAT PUMP MODELS

Btu/h		9,000	12,000	18,000	24,000	26,000	30,000	36,000	42,000
MODEL (System)		XE12PKUA E9NKUA	XE9PKUA, E12NKUA KE12NB41	E18NKUA KE18NB4U	E24NKUA	Z6PEK1U6, Z6PET1U6 Z6PEU1U6, Z6PEF1U6	KE30NKU	KE36NKU, 36PET1U6 36PEU1U6, 36PEF1U6	42PET1U6 42PEU1U6
Low Ambient Type	EXTERIOS								
	Wall Mounted								
	Wall Mounted								
	Wall Mounted								
	Ceiling Suspended								
	Ceiling Recessed								
	Concealed Duct								
Outdoor									

### COOLING ONLY MODELS / STANDARD TYPE

Btu/h		9,000	12,000	18,000	22,000
MODEL (System)		S9NKU-1	S12NKU-1	S18NKU-1, KS18NKU KS18NB4U	S22NKU-1
Standard Type	AIR CONDITIONER				
	Wall Mounted				
		CS-S9NKUW-1 CU-S9NKU-1	CS-S12NKUW-1 CU-S12NKU-1	CS-S18NKU-1 CU-S18NKU-1	CS-S22NKU-1 CU-S22NKU-1

### COOLING ONLY MODELS / LOW AMBIENT TYPE

Btu/h		9,000	12,000	18,000	24,000	26,000	30,000	36,000	42,000
MODEL (System)		S9NKUA	S12NKUA KS12NB41A	S18NKUA KS18NB4UA	S24NKUA	Z6PSK1U6, Z6PST1U6 Z6PSU1U6, Z6PSF1U6	KS30NKUA	KS36NKUA, 36PST1U6 36PSU1U6, 36PSF1U6	42PST1U6 42PSU1U6
Low Ambient Type	Wall Mounted								
	Wall Mounted								
	Ceiling Suspended								
	Ceiling Recessed								
	Concealed Duct								
	Outdoor								

### MULTI ZONE MODELS

Series		S series / E series					KS series / KE series				
Btu/h		9,000	12,000	18,000	24,000	26,000	30,000	36,000	42,000		
AIR CONDITIONER	Indoor Unit										
	Outdoor Unit										
	Outdoor Unit										
HEAT PUMP	Indoor Unit										
	Outdoor Unit										
	Outdoor Unit										



OP: Option

		HEAT PUMPS							STANDARD	LOW-AMBIENT AIR CONDITIONERS															
		XE9PKUA XE12PKUA	E9NKUA E12NKUA E18NKUA E24NKUA	KE30NKU KE36NKU		26PEK1U6			S9NKU-1 S12NKU-1 S18NKU-1 S22NKU-1	S9NKUA S12NKUA S18NKUA S24NKUA	KS30NKUA KS36NKUA		26PSK1U6			26PST1U6 36PST1U6 42PST1U6			26PSU1U6 36PSU1U6 42PSU1U6						
	Wall Mounted																								
	Ceiling Suspended																								
	Ceiling Recessed																								
	Concealed Duct																								
	ECONAVI	●																							
	Room Freeze Protection	●																							
	Microprocessor-Controlled Operation	●	●	●	●	●	●	●	●	●	●	●	●	●	●	●	●	●	●	●	●	●	●	●	●
	Wireless Remote Control	●	●	●	●	●	●	●	OP	OP	OP	OP	OP	OP	OP	OP	OP	OP	OP	OP	OP	OP	OP	OP	OP
	Wired Remote Control	OP	OP	OP	OP	OP	OP	OP	●	●	●	●	●	●	●	●	●	●	●	●	●	●	●	●	●
	Self-Diagnosing Function	●	●	●	●	●	●	●	●	●	●	●	●	●	●	●	●	●	●	●	●	●	●	●	●
	Dry Mode	●	●	●	●	●	●	●	●	●	●	●	●	●	●	●	●	●	●	●	●	●	●	●	●
	5 Fan Speeds and Automatic Fan Operation	●	●	●	●	●	●	●	●	●	●	●	●	●	●	●	●	●	●	●	●	●	●	●	●
	Air Sweep Control	●	●	●	●	●	●	●	-	●	●	●	●	●	●	●	●	●	●	●	●	●	●	●	●
	Louver Control	●	●	●	●	●	●	●	-	●	●	●	●	●	●	●	●	●	●	●	●	●	●	●	●
	Automatic Heating and Cooling Changeover	●	●	●	●	●	●	●	-	-	-	-	-	-	-	-	-	-	-	-	-	-	-	-	-
	Night Setback Mode for Cooling and Heating	-	-	-	●	-	-	-	-	-	-	-	●	●	-	-	-	-	-	-	-	-	-	-	-
	Hot Start Heating System	●	●	●	●	●	●	●	-	-	-	-	-	-	-	-	-	-	-	-	-	-	-	-	-
	24-Hour Clock with ON/OFF Program Timer	●	●	●	●	●	●	●	●	●	●	●	●	●	●	●	●	●	●	●	●	●	●	●	●
	1-Hour OFF Timer	-	-	●	●	-	-	-	-	-	-	-	-	-	-	-	-	-	-	-	-	-	-	-	-
	Weekly Timer	-	-	-	-	OP	●	●	-	-	-	-	-	OP	●	●	●	●	●	●	●	●	●	●	
	System Controller	-	-	-	-	OP	OP	OP	OP	OP	OP	OP	OP	OP	OP	OP	OP	OP	OP	OP	OP	OP	OP	OP	OP
	Filter Sign	●	●	-	-	●	●	●	●	●	●	●	●	●	●	●	●	●	●	●	●	●	●	●	●
	Automatic Restart Function after Power Failure	●	●	●	●	●	●	●	●	●	●	●	●	●	●	●	●	●	●	●	●	●	●	●	●
	Fresh Air Intake	-	-	-	●	-	OP*	OP	OP*	-	-	-	●	-	OP*	OP	OP*	OP*	OP	OP*	OP	OP	OP	OP*	
	Branch Extension	-	-	-	●	-	-	●	-	-	-	-	●	-	●	●	●	●	●	●	●	●	●	●	
	Built-In Drain Pump	-	-	-	●	-	-	●	-	-	-	-	●	-	-	-	●	●	●	●	●	●	●	●	
	Low Ambient Operation	●	●	●	-	●	●	●	-	●	●	●	●	●	●	●	●	●	●	●	●	●	●	●	
	Electric Expansion Valve	●	●	●	●	●	●	●	●	●	●	●	●	●	●	●	●	●	●	●	●	●	●	●	
	ODP=0 Refrigerant	●	●	●	●	●	●	●	●	●	●	●	●	●	●	●	●	●	●	●	●	●	●	●	
	Quiet Mode	●	●	●	●	-	-	-	●	●	●	●	●	●	●	●	●	-	-	-	-	-	-	-	
	Anti-microbial Filter	-	●	-	-	-	-	-	●	●	●	●	●	●	●	●	-	-	-	-	-	-	-	-	
	Blue Fin Condenser	●	●	-	-	-	-	-	●	●	●	●	●	●	●	●	-	-	-	-	-	-	-	-	

\* Field Supplied

## ECONAVI

ECONAVI features intelligent Human Activity Sensor and new technologies that can detect human activity and absence, and optimize air conditioner operation according to room conditions.

## Room Freeze Protection\*

Room Freeze Protection mode helps prevent plumbing damage due to sub-freezing temperature. This mode automatically turns on the compressor for heat pump operation if the room temperature falls to about 46°F.

\*This function may not be performed if the unit is not powered, or if the unit is unable to operate such as in protection mode. Please consult with the HVAC installers or professional for details.

## Microprocessor-Controlled Operation

Microprocessor control ensures that the temperature and humidity levels in the room are always comfortable.

## Wireless Remote Control

Panasonic's infrared Remote Control with an easy-to-read LCD Display, gives the user the capability to adjust & set: temperature, sweep (louver control), fan speeds, timer and more, for complete automatic operation.

## DRY Dry Mode

By coupling compressor and fan operation, intermittent operation can be precisely controlled according to room temperature, so that air is efficiently dehumidified.

## 5 Fan Speeds and Automatic Fan Operation

Convenient microprocessor control automatically adjusts fan speed to High, Medium or Low. According to room temperature to maintain a comfortable airflow throughout the room.

## Air Sweep Control

The air sweep function moves the louver up and down in the air outlet, directing air in a "sweeping" motion around the room and providing comfort in every corner.

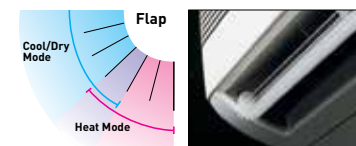

## Louver Control

Louver can be manually set to the desired angle by remote control.

## Automatic Heating and Cooling Changeover

After setting the temperature and functions you desire, just relax. If the room temperature is higher than the set temperature, cooling operation begins. If the room temperature is lower than the set temperature, heating operation begins. During normal thermostat cycle operation, cooling and heating operations automatically change in accordance with set temperature, time and room temperature (Single Zone Heat Pump unit only).

## 1H 1-hour OFF Timer

When this button is pushed either while the unit is operating or while it is stopped, the unit will operate for one hour, then switch off automatically.

## 24H 24-hour Clock with ON/OFF Program Timer

The remote control unit allows you to set a wide variety of timer-based operations. Such functions include automatic ON/OFF with a timer setting, same time ON/OFF every day, ON timer, OFF timer and Combination timer.

## Night Setback Mode for Cooling and Heating

**Cooling and DRY Mode:** With the Night Setback Mode, the air conditioner automatically raises the setting temperature 2°F after 30 minutes, and then another 2°F after the next 30 minutes.

**Heating Mode:** With the Night Setback Mode, the setting temperature is automatically lowered 4°F after 30 minutes, and then another 4°F after the next 30 minutes. This saves energy without sacrificing comfort and is ideal for gentle cooling and heating.

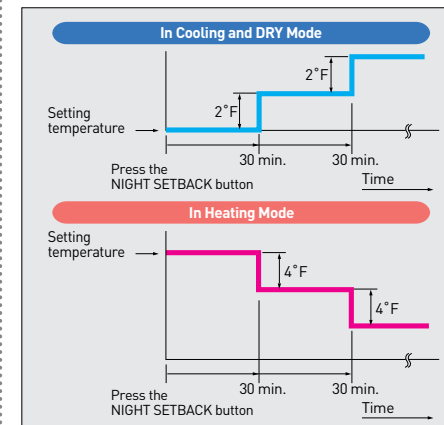

## Automatic Restart Function after Power Failure

This feature allows the system to automatically resume operation at its preset program, after power is restored from a power failure when the remote control is in the room.

## Hot Start Heating System

Right from the start, air is warm and comfortable. The Hot Start Heating System prevents any cold blasts at the beginning while the heat pump is warming up (Heat pump unit only).

## DP Built-In Drain Pump

Max. head 20 inches from the discharge of the indoor unit. Condensation pump is only for allowing drain line to meet minimum gravity flow requirements.

## Electric Refrigerant Control Valve

The circulation volume of the refrigerant is controlled by a pulse type electric control valve. In order to attain optimum efficiency, when the power is switched ON, the opening degree of the electric control valve is controlled between 90 and 480 steps.

## Quiet Mode

LOW, low fan speed for extra quiet operation.

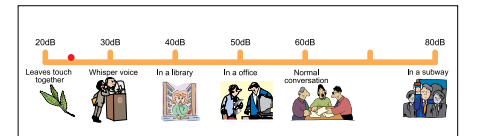

## Filter Sign

Filter sign informs you when filter maintenance is necessary.

K1/T1/U1/F1 series with CZ-RTC2  
XE/E/S series with CZ-RDC516C-1



## Self-Diagnosing Function

Units are equipped with Self-Diagnosing Function (methods are difference depending on the models). This makes it easier to diagnose malfunctions, greatly reducing service labor (Wired remote controller).



## Anti-microbial Filter

Anti-microbial Filter by 3M. This filter is treated to inhibit the growth of mold and mildew, and helps create clean air.

## Test Comparison

	Microbial Growth Rating	
	7 days	28days
Anti-microbial Filter	No growth	No growth
Normal Filter Paper	60% growth	60% growth

\*Tested per ASTM G21-96

## Blue Fin Condenser

Condensers can take a beating from exposure to salty air, rain and other corrosive factors. Panasonic has extended the life of its condensers with an original anti-rust coating. Tested for 2,000 salt spray hours.

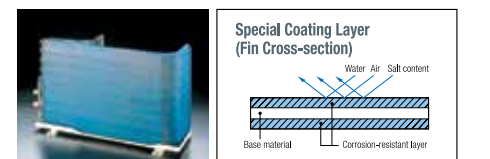



# Panasonic sets another milestone in the Mini-Split History...

EXTERIOS - the latest breakthrough in energy efficiency and high performance with Inverter technology, SEER 28.5 and HSPF 12.5

## EXTERIOS

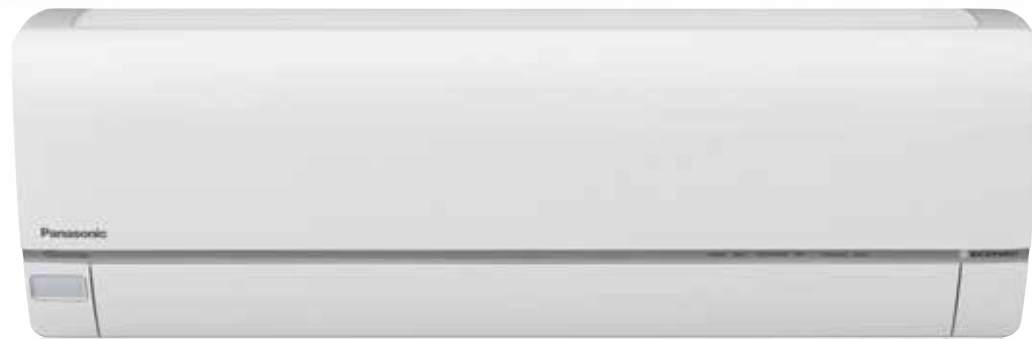

Indoor Unit  
CS-XE9PKUA / CS-XE12PKUA



Wireless Remote Controller



Wired Remote Controller (CZ-RD516-1) (Optional)



### High Energy Efficiency

Breakthrough technologies, such as the inverter, enable the highest energy efficiency\* in the industry. Thanks to this exceptional performance, you will enjoy even more comfort.

\*CS/CU-XE9PKUA as of March 2013



### Powerful Heating at Low Ambient Temperatures

Offers reliable heating with full capacity down to 5° F.

XE9PKUA Max Capacity (Heat)

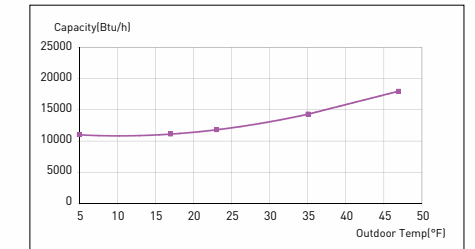

### Inverter Technology

Panasonic's inverter technology provides optimum power control and extremely efficient operation by modulating the compressor capacity. The result is efficient and flexible operation using less electricity.



### Panasonic ductless mini split systems are designed to care for you

With over 50 years of experience of exporting to more than 125 countries around the world, Panasonic is unquestionably one of the leaders in the air conditioning business. Panasonic has produced more than 200 million compressors and has manufactured high quality air conditioners.



## Provides Optimum Performance While Reducing Energy Usage

Panasonic's inverter technology constantly adjusts its compressor rotation speed to provide maximum performance at all times. This extremely precise operation enables quick cooling or heating while reducing power consumption compared to conventional non-inverter units.

### Reduces Electricity Consumption

Panasonic inverter air conditioners/heat pumps are designed to give you exceptional energy savings performance while ensuring you stay comfortable at all times.

### Constant Comfort

Precise temperature control with a wide power output range enables an inverter air conditioner to meet different room occupancy levels – thus ensuring constant comfort.

### Quick Cooling and Heating

Panasonic Inverter air conditioners can operate with higher cooling/heating power during the start up period to cool/heat the room faster than non-inverter models.

### Whisper Quiet Operation

The indoor operating noise has been reduced by 5dB as the Inverter constantly varies its output power to enable more precise temperature control.

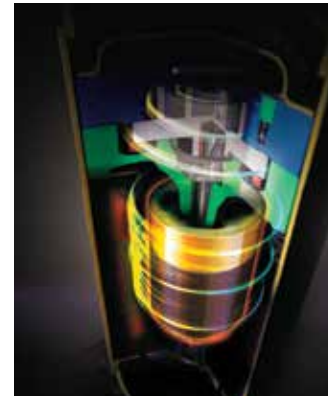

### Wider Output Power Range

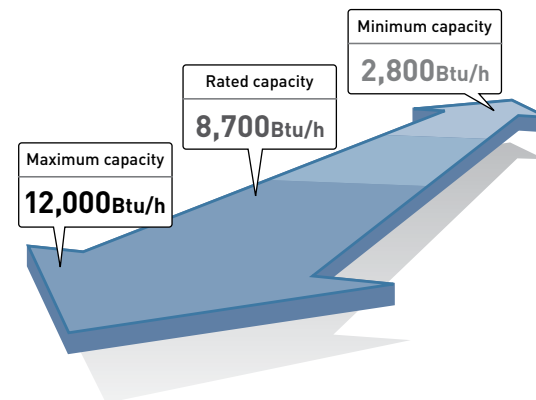

### The Advantages of Inverter Control

Comparing inverter and non-inverter air conditioners to cars...

\*Image of output power fluctuation

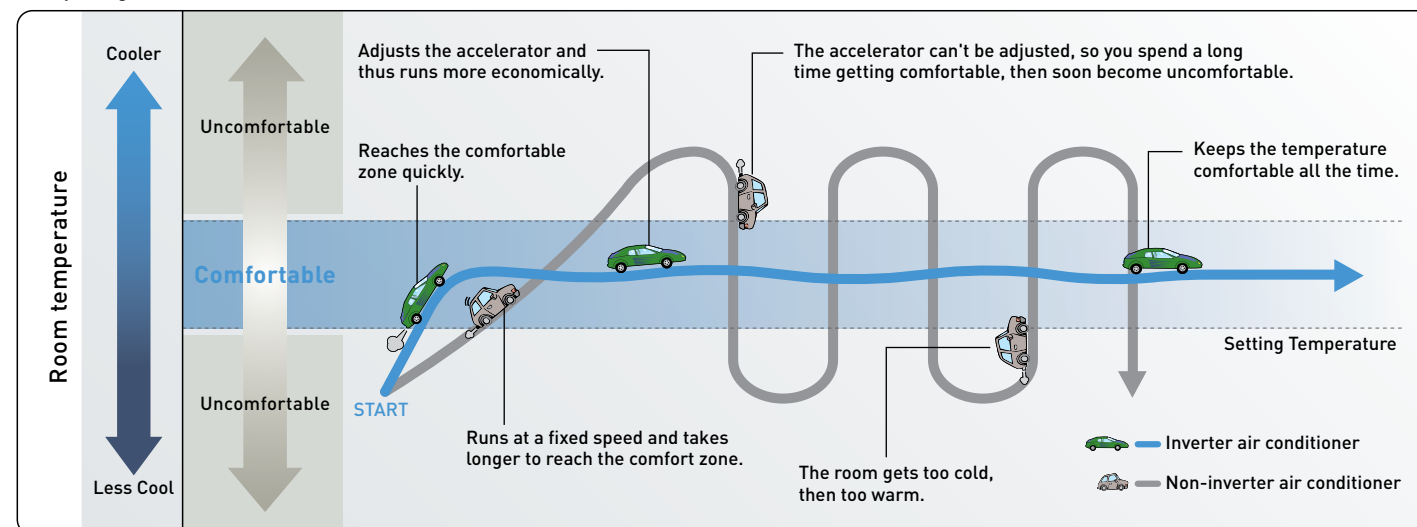

## ECONAVI with Intelligent Eco Sensors



In 2007, Panasonic launched ECONAVI (Human Detection Technology) to its air conditioners. The ECONAVI sensors moderate the temperature in a room and senses when there is activity, which then automatically adjusts the temperature setting accordingly for maximum energy efficient operation. The absence detection feature switches to a slightly less powerful cooling mode when the room is empty.

### Absence Detection

ECONAVI detects human absence from the room and raises the target temperature.

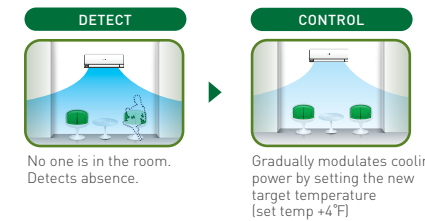

### Activity Detection

ECONAVI detects changes in activity levels and reduces the cooling power by adjusting set temperature.

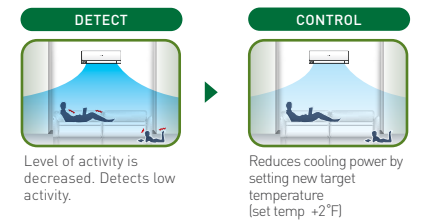

ECONAVI in cooling mode: \*The target temperature set by ECONAVI will be restored automatically to the set temperature when the new condition is detected.



### How Does ECONAVI Human Activity Work?

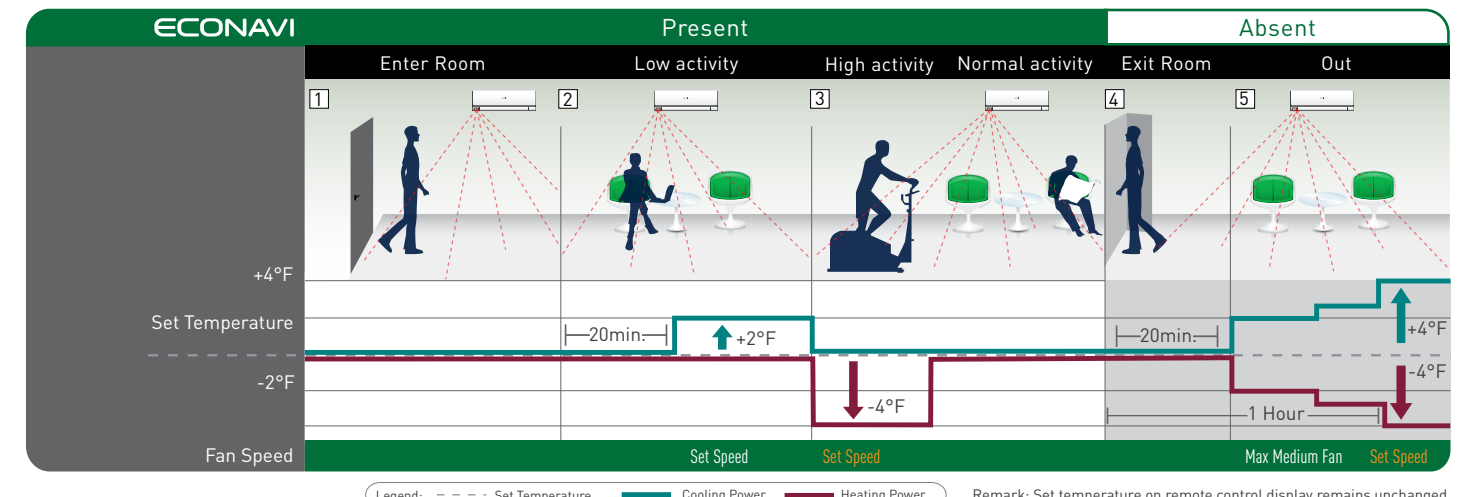



# Wall-Mounted Heat Pumps

# Wall-Mounted Heat Pumps

## XE9PKUA / XE12PKUA EXTERIOS



Indoor Unit  
CS-XE9PKUA / CS-XE12PKUA



Outdoor Unit  
CU-XE9PKUA / CU-XE12PKUA



Wireless Remote Controller



Wired Remote Controller (CZ-RD516C-1) (Optional)



## E9NKUA / E12NKUA



Indoor Unit  
CS-E9NKUAW / CS-E12NKUAW



Outdoor Unit  
CU-E9NKUA / CU-E12NKUA



Wireless Remote Controller



Wired Remote Controller (CZ-RD516C-1) (Optional)

## E18NKUA / E24NKUA



Indoor Unit  
CS-E18NKUA / CS-E24NKUA



Outdoor Unit  
CU-E18NKUA / CU-E24NKUA



Wireless Remote Controller



Wired Remote Controller (CZ-RD516C-1) (Optional)



Wall Mounted Heat Pumps									
Model No.	XE9PKUA			XE12PKUA					
Unit Model No.	Indoor Unit CS-XE9PKUA		Outdoor Unit CU-XE9PKUA	Indoor Unit CS-XE12PKUA		Outdoor Unit CU-XE12PKUA			
<b>Performance &amp; Electrical Ratings</b>									
Capacity	Cooling	Btu/h	8,700(2,800-12,000)			11,500(2,800-14,000)			
	Heating	Btu/h	12,000(3,000-18,000) (110,600 at 17°F)			13,800(3,000-23,000) (113,500 at 17°F)			
Moisture Removal	High	Pints/H	1.3			2.3			
	High	CFM	405			530			
SEER	Cooling		28.5			25.5			
EER	Cooling		14.35			14.35			
HSPF	Heating		12.5			12.0			
Power Supply	V, Phase, Hz		230/208V, 1PH, 60Hz			230/208V, 1PH, 60Hz			
Running Amps	Cooling	A	2.5/2.8			3.8/4.2			
	Heating	A	4.0/4.5			5.2/5.8			
Power Input	Cooling	W	540(150-850)			800(250-850)			
	Heating	W	860(150-1,650)			1,150(200-2,100)			
Back-up Heater		kW	---			---			
Fuse or Circuit Breaker	Capacity	A	15			20			
<b>Features</b>									
Controls	Microprocessor			Microprocessor					
Low Ambient Control	Equipped			Equipped					
Wireless Remote Controller	Included			Included					
Wired Remote Controller (optional)	CZ-RD516C-1			CZ-RD516C-1					
Fan Speeds	5 Speeds + Auto			5 Speeds + Auto					
Timer	24hr Program			24hr Program					
Air Deflection	Horizontal	Manual			Manual				
	Vertical	Automatic			Automatic				
Air Filter	Washable + Anti Microbial Filter			Washable + Anti Microbial Filter					
Refrigerant	R-410A			R-410A					
Refrigerant control	Electric Expansion Valve			Electric Expansion Valve					
Operation Sound	In(Hi / Lo / Q-Lo)	dB-A	42 / 25 / 20			45 / 25 / 20			
	Outdoor(Hi)	dB-A	48			49			
Refrigerant Piping	Type		Flare			Flare			
	Discharge	inches	1/4"			1/4"			
	Suction	inches	3/8"			1/2"			
Refrigerant Pipe Length		Fl.	Max. 66			Max. 66			
Elevation Difference*	Outdoor Above	Fl.	Max. 49			Max. 49			
	Outdoor Below	Fl.	Max. 49			Max. 49			
<b>Dimensions &amp; Weight</b>									
Height		inches	Indoor Unit		Outdoor Unit				
			11-5/8"		27-3/8"		11-5/8" 27-3/8"		
Width		inches	34-9/32"		34-15/32"				
			34-9/32"		34-15/32"		34-9/32" 34-15/32"		
Depth		inches	10-1/16"		12-5/8"				
			10-1/16"		12-5/8"		10-1/16" 12-5/8"		
Net Weight		Lbs.	24		97				

\* This is maximum elevation difference when the indoor unit is located above the outdoor unit. (Refer to the table on the P.34 in the catalog for more detail.)

Wall Mounted Heat Pumps											
Model No.	E9NKUA		E12NKUA		E18NKUA		E24NKUA				
Unit Model No.	Indoor Unit CS-E9NKUAW		Outdoor Unit CU-E9NKUA	Indoor Unit CS-E12NKUAW		Outdoor Unit CU-E12NKUA	Indoor Unit CS-E18NKUA		Outdoor Unit CU-E18NKUA		
<b>Performance &amp; Electrical Ratings</b>											
Capacity	Cooling	Btu/h	8,500(4,100-10,200)		12,000(4,100-13,300)		17,100(5,800-19,800)		24,000(5,800-27,200)		
	Heating	Btu/h	11,200(4,100-14,100)		13,800(4,100-16,300)		20,400(5,800-20,800)		28,800(5,800-29,200)		
Moisture Removal	High	Pints/H	1.3		2.5		3.0		7.6		
	High	CFM	395		425		650		650		
SEER	Cooling		21.0		20.0		18.0		17.5		
EER	Cooling		13.1		12.0		13.2		10.2		
HSPF	Heating		10.5		10.6		8.5		8.5		
Power Supply	V, Phase, Hz		230/208V, 1PH, 60Hz		230/208V, 1PH, 60Hz		230/208V, 1PH, 60Hz		230/208V, 1PH, 60Hz		
Running Amps	Cooling	A	3.1(-7)		4.7(-7.8)		6.30 / 7.20		10.80 / 11.90		
	Heating	A	5.4(-7.5)		5.8(-7.8)		7.50 / 8.60		11.40 / 12.40		
Power Input	Cooling	W	650(250-850)		1,000(250-1,150)		1,300(430-1,600)		2,350(430-2,720)		
	Heating	W	1,150(200-1,500)		1,300(200-1,710)		1,600(380-1,650)		2,500(380-2,660)		
Back-up Heater		kW	---		---		---		---		
Fuse or Circuit Breaker	Capacity	A	15		15		20		20		
<b>Features</b>											
Controls	Microprocessor		Microprocessor		Microprocessor		Microprocessor		Microprocessor		
Low Ambient Control	Equipped		Equipped		Equipped		Equipped		Equipped		
Wireless Controller	Included		Included		Included		Included		Included		
Wired Remote Controller (optional)	CZ-RD516C-1		CZ-RD516C-1		CZ-RD516C-1		CZ-RD516C-1		CZ-RD516C-1		
Fan Speeds	5 Speeds + Auto		5 Speeds + Auto		5 Speeds + Auto		5 Speeds + Auto		5 Speeds + Auto		
Timer	24hr Program		24hr Program		24hr Program		24hr Program		24hr Program		
Air Deflection	Horizontal	Manual		Manual		Automatic		Automatic		Automatic	
	Vertical	Automatic		Automatic		Automatic		Automatic		Automatic	
Air Filter	Washable + Anti Microbial Filter		Washable + Anti Microbial Filter		Washable + Anti Microbial Filter		Washable + Anti Microbial Filter		Washable + Anti Microbial Filter		
Refrigerant	R-410A		R-410A		R-410A		R-410A		R-410A		
Refrigerant control	Electric Expansion Valve		Electric Expansion Valve		Electric Expansion Valve		Electric Expansion Valve		Electric Expansion Valve		
Operation Sound	In(Hi / Me / Lo / Qt)	dB-A	40 / 25 / 20		43 / 28 / 20		47/39/36		48/40/37		
	Outdoor(Hi)	dB-A	47		48		49		51		
Refrigerant Piping	Type		Flare		Flare		Flare		Flare		
	Discharge	inches	1/4"		1/4"		1/4"		1/4"		
	Suction	inches	3/8"		1/2"		1/2"		5/8"		
Refrigerant Pipe Length		Fl.	Max. 66		Max. 66		Max. 100		Max. 100		
Elevation Difference*	Outdoor Above	Fl.	Max. 49		Max. 49		Max. 49		Max. 49		
	Outdoor Below	Fl.	Max. 49		Max. 49		Max. 49		Max. 49		
<b>Dimensions &amp; Weight</b>											
Height		inches	Indoor Unit		Outdoor Unit		Indoor Unit		Outdoor Unit		
			11-7/16"		21-9/32"		11-7/16"		21-9/32"		
Width		inches	34-9/32"		30-23/32"		34-9/32"		30-23/32"		
			34-9/32"		30-23/32"		42-5/32"		34-15/32"		
Depth		inches	8-1/16"		11-13/32"		8-1/16"		11-13/32"		
			8-1/16"		11-13/32"		9-9/32"		12-5/8"		
Net Weight		Lbs.	20.0		82.0		20.0		82.0		

\* This is maximum elevation difference when the indoor unit is located above the outdoor unit. (Refer to the table on the P.34 in the catalog for more detail.)

# Wall-Mounted Heat Pumps

## 26PEK1U6



Indoor Unit  
S-26PK1U6

## KE30NKU / KE36NKU



Indoor Unit  
CS-KE30NKU / CS-KE36NKU



Outdoor Unit  
U-26PE1U6



Wireless Remote Controller



Wired Remote Controller  
CZ-RTC2 (optional)



Outdoor Unit  
CU-KE30NKU / CU-KE36NKU



Wireless Remote Controller



Wired Remote Controller  
CZ-RD515U (optional)



# Wall-Mounted Air Conditioners

Standard Models

## S9NKU-1 / S12NKU-1



Indoor Unit  
CS-S9NKUW-1 / CS-S12NKUW-1



Outdoor Unit  
CU-S9NKU-1 / CU-S12NKU-1



Wireless Remote Controller



## S18NKU-1 / S22NKU-1



Indoor Unit  
CS-S18NKU-1 / CS-S22NKU-1



Outdoor Unit  
CU-S18NKU-1 / CU-S22NKU-1



Wireless Remote Controller



(S18/22 only)

### Wall Mounted Heat Pumps

Model No.	26PEK1U6		KE30NKU		KE36NKU	
	Indoor Unit S-26PK1U6	Outdoor Unit U-26PE1U6	Indoor Unit CS-KE30NKU	Outdoor Unit CU-KE30NKU	Indoor Unit CS-KE36NKU	Outdoor Unit CU-KE36NKU
<b>Performance &amp; Electrical Ratings</b>						
Capacity	Cooling Btu/h	25,200 (9,500-25,200)	30,600 (10,900-30,600)	34,000 (10,900-34,000)	30,600 (10,900-30,600)	34,000 (10,900-34,000)
	Heating Btu/h	29,200 (8,000-29,200)	33,000 (14,000-33,000)	36,000 (14,000-36,000)	33,000 (14,000-33,000)	36,000 (14,000-36,000)
Moisture Removal	High Pints/H	8.1	9.57	10.64	8.1	9.57
Dry Air Flow	Hi / Med / Low CFM	559 / 475 / 390	630 / 530 / 412	630 / 530 / 412	559 / 475 / 390	630 / 530 / 412
SEER	Cooling	14.9	16	16	14.9	16
EER	Cooling	8.9	9.3	8.5	8.9	9.3
HSPF	Heating	10.2	9.0	9.0	10.2	9.0
Power Supply	V, Phase, Hz	230V / 208V, 1PH, 60Hz	230 / 208V, 1PH, 60Hz	230 / 208V, 1PH, 60Hz	230V / 208V, 1PH, 60Hz	230 / 208V, 1PH, 60Hz
Running Amps	Cooling A	15.3 / 16.9	16.5 (5 - 16.5) / 18.0	20 (5 - 20) / 21.9	15.3 / 16.9	16.5 (5 - 16.5) / 18.0
	Heating A	14.0 / 15.5	15.3 (4.5 - 15.3) / 16.3	18.2 (4.5 - 18.2) / 19.9	14.0 / 15.5	15.3 (4.5 - 15.3) / 16.3
Power Input	Cooling W	2,840 / 2,840	3,290	4,000	2,840 / 2,840	3,290
	Heating W	2,620 / 2,620	3,070	3,650	2,620 / 2,620	3,070
Back-up Heater	kW	---	---	---	---	---
Fuse or Circuit Breaker Capacity	A	15	30	35	15	45
<b>Features</b>						
Controls	Microprocessor		Microprocessor		Microprocessor	
Low Ambient Control	Built-in 0° F		Built-in 0° F		Built-in 0° F	
Wireless Remote Controller	Included		Included		Included	
Wired Remote Controller (optional)	CZ-RTC2		CZ-RD515U & CZ-RC515UA		CZ-RD515U & CZ-RC515UA	
Fan Speeds	3 and Automatic Control / Variable		Hi / Me / Lo & Auto		Hi / Me / Lo & Auto	
Timer	24-hr Program		1hr OFF and 24-hr Program		1hr OFF and 24-hr Program	
Air Deflection	Horizontal	---	Manual	Manual	Manual	Manual
	Vertical	---	Automatic	Automatic	Automatic	Automatic
Air Filter	Washable		Washable		Washable	
Refrigerant	R-410A		R-410A		R-410A	
Refrigerant control	Electric Expansion Valve		Electric Expansion Valve		Electric Expansion Valve	
Operation Sound	In(Hi / Me / Lo / Qt) dB-A	41 / 37 / 34	49 / 44 / 39	49 / 44 / 39	41 / 37 / 34	49 / 44 / 39
	Outdoor(Hi) dB-A	49	55	55	49	55
Refrigerant Piping	Type	Flare	Flare	Flare	Flare	Flare
	Discharge inches	3/8"	3/8"	3/8"	3/8"	3/8"
	Suction inches	5/8"	5/8"	5/8"	5/8"	5/8"
Refrigerant Pipe Length	Ft.	Max. 165	Max. 164	Max. 164	Max. 165	Max. 164
Elevation Difference*	Outdoor Above Ft.	Max. 100	Max. 100	Max. 100	Max. 100	Max. 100
	Outdoor Below Ft.	Max. 50	Max. 50	Max. 50	Max. 50	Max. 50
<b>Dimensions &amp; Weight</b>						
Height	inches	12-63/64"	30-23/32"	11-3/16"	35-13/16"	11-3/16"
Width	inches	44-7/8"	37"	41-15/16"	37-1/32"	41-15/16"
Depth	inches	8-31/32"	13-3/8"	9-1/16"	13-3/8"	9-1/16"
Net Weight	Lbs.	40.0	128.0	32.0	185.0	32.0

\* This is maximum elevation difference when the indoor unit is located above the outdoor unit. (Refer to the table on the P.34 in the catalog for more detail.)

### Wall Mounted Air Conditioners

Model No.	S9NKU-1		S12NKU-1		S18NKU-1		S22NKU-1	
	Indoor Unit CS-S9NKUW-1	Outdoor Unit CU-S9NKU-1	Indoor Unit CS-S12NKUW-1	Outdoor Unit CU-S12NKU-1	Indoor Unit CS-S18NKU-1	Outdoor Unit CU-S18NKU-1	Indoor Unit CS-S22NKU-1	Outdoor Unit CU-S22NKU-1
<b>Performance &amp; Electrical Ratings</b>								
Capacity	Cooling Btu/h	8,500(4,100-10,200)	11,900(4,100-13,100)	17,100(4,400-19,800)	21,000(4,400-23,400)	8,500(4,100-10,200)	11,900(4,100-13,100)	17,100(4,400-19,800)
	Heating Btu/h	---	---	---	---	---	---	---
Moisture Removal	High Pints/H	1.3	2.3	3.6	6.1	1.3	2.3	3.6
Dry Air Flow	High CFM	400	425	650	650	400	425	650
SEER	Cooling	17.5	17.5	17.5	17.0	17.5	17.5	17.0
EER	Cooling	12.1	11.9	10.4	9.3	12.1	11.9	10.4
HSPF	Heating	---	---	---	---	---	---	---
Power Supply	V, Phase, Hz	230/208V, 1PH, 60Hz	230/208V, 1PH, 60Hz	230/208V, 1PH, 60Hz	230/208V, 1PH, 60Hz	230/208V, 1PH, 60Hz	230/208V, 1PH, 60Hz	230/208V, 1PH, 60Hz
Running Amps	Cooling A	3.3(3.7-4.1)	4.6(5.1-5.4)	7.5(-9)	10(-10.8)	3.3(3.7-4.1)	4.6(5.1-5.4)	7.5(-9)
	Heating A	---	---	---	---	---	---	---
Power Input	Cooling W	700(250-900)	1,000(250-1,150)	1,650(250-1,950)	2,250(250-2,550)	700(250-900)	1,000(250-1,150)	1,650(250-1,950)
	Heating W	---	---	---	---	---	---	---
Back-up Heater	kW	---	---	---	---	---	---	---
Fuse or Circuit Breaker Capacity	A	15	15	20	25	15	15	20
<b>Features</b>								
Controls	Microprocessor		Microprocessor		Microprocessor		Microprocessor	
Low Ambient Control	---		---		---		---	
Wireless Remote Controller	Included		Included		Included		Included	
Wired Remote Controller (optional)	---		---		---		---	
Fan Speeds	5 Speeds + Auto		5 Speeds + Auto		5 Speeds + Auto		5 Speeds + Auto	
Timer	24hr Program		24hr Program		24hr Program		24hr Program	
Air Deflection	Horizontal	Manual	Manual	Automatic	Automatic	Automatic	Automatic	Automatic
	Vertical	Automatic	Automatic	Automatic	Automatic	Automatic	Automatic	Automatic
Air Filter	Washable + Anti Microbial Filter		Washable + Anti Microbial Filter		Washable + Anti Microbial Filter		Washable + Anti Microbial Filter	
Refrigerant	R-410A		R-410A		R-410A		R-410A	
Refrigerant control	Capillary Tube		Capillary Tube		Electric Expansion Valve		Electric Expansion Valve	
Operation Sound	In(Hi / Lo / Q-Lo) dB-A	40 / 25 / 20	43 / 28 / 20	47 / 39 / 36	47 / 39 / 36	40 / 25 / 20	43 / 28 / 20	47 / 39 / 36
	Outdoor(Hi) dB-A	47	48	47	50	47	48	47
Refrigerant Piping	Type	Flare	Flare	Flare	Flare	Flare	Flare	Flare
	Discharge inches	1/4"	1/4"	1/4"	1/4"	1/4"	1/4"	1/4"
	Suction inches	3/8"	1/2"	1/2"	5/8"	3/8"	1/2"	5/8"
Refrigerant Pipe Length	Ft.	Max. 49	Max. 49	Max. 66	Max. 66	Max. 49	Max. 49	Max. 49
Elevation Difference*	Outdoor Above Ft.	Max. 16	Max. 16	Max. 16	Max. 16	Max. 16	Max. 16	Max. 16
	Outdoor Below Ft.	Max. 16	Max. 16	Max. 16	Max. 16	Max. 16	Max. 16	Max. 16
<b>Dimensions &amp; Weight</b>								
Height	inches	11-7/16"	21-9/32"	11-7/16"	21-9/32"	11-7/16"	31-5/16"	11-7/16"
Width	inches	34-9/32"	30-23/32"	34-9/32"	30-23/32"	42-5/32"	34-15/32"	34-15/32"
Depth	inches	8-1/16"	11-13/32"	8-1/16"	11-13/32"	9-9/32"	12-5/8"	9-9/32"
Net Weight	Lbs.	20.0	82.0	20.0	82.0	26.0	115.0	26.0

\* This is maximum elevation difference when the indoor unit is located above the outdoor unit. (Refer to the table on the P.34 in the catalog for more detail.)



# Wall-Mounted Air Conditioners

Low Ambient Models

## S9NKUA / S12NKUA



**Indoor Unit**  
CS-S9NKUA / CS-S12NKUA



**Outdoor Unit**  
CU-S9NKUA / CU-S12NKUA



Wireless Remote Controller



Wired Remote Controller CZ-RD516C-1 (optional)

## S18NKUA / S24NKUA



**Indoor Unit**  
CS-S18NKUA / CS-S24NKUA



(S18 Only)



**Outdoor Unit**  
CU-S18NKUA / CU-S24NKUA



Wireless Remote Controller



Wired Remote Controller CZ-RD516C-1 (optional)



# Wall-Mounted Air Conditioners

Low Ambient Models

## 26PSK1U6



**Indoor Unit**  
S-26PK1U6



**Outdoor Unit**  
U-26PS1U6



Wireless Remote Controller



Wired Remote Controller CZ-RTC2 (optional)



## KS30NKUA / KS36NKUA



**Indoor Unit**  
CS-KS30NKU/CS-KS36NKU



**Outdoor Unit**  
CU-KS30NKUA / CU-KS36NKUA



Wireless Remote Controller



Wired Remote Controller CZ-RD515U (optional)

Model No.	S9NKUA		S12NKUA		S18NKUA		S24NKUA	
	Indoor Unit CS-S9NKUA	Outdoor Unit CU-S9NKUA	Indoor Unit CS-S12NKUA	Outdoor Unit CU-S12NKUA	Indoor Unit CS-S18NKUA	Outdoor Unit CU-S18NKUA	Indoor Unit CS-S24NKUA	Outdoor Unit CU-S24NKUA
<b>Performance &amp; Electrical Ratings</b>								
Capacity	Cooling Btu/h	8,500 (4,100-10,200)	12,000 (4,100-13,300)	17,100(5,800-19,800)	24,000(5,800-27,200)			
	Heating Btu/h	---	---	---	---			
Moisture Removal	High Pints/H	1.3	2.5	3.0	---			
Dry Air Flow	High CFM	395	425	650	---			
SEER	Cooling	21.0	20.0	18.0	17.5			
EER	Cooling	13.1	12.0	13.2	10.2			
HSPF	Heating	---	---	---	---			
Power Supply	V, Phase, Hz	230/208V, 1PH, 60Hz	230/208V, 1PH, 60Hz	230/208V, 1PH, 60Hz	230/208V, 1PH, 60Hz			
Running Amps	Cooling A	3.1/3.5(-4.4)	4.7/5.2(-6.8)	6.3/7.2	10.7/5/11.90			
	Heating A	---	---	---	---			
Power Input	Cooling W	650(250-850)	1,000(250-1,150)	1,300(430-1,600)	2,350(430-2,720)			
	Heating W	---	---	---	---			
Back-up Heater	kW	---	---	---	---			
Fuse or Circuit Breaker Capacity	A	15	15	20	25			
<b>Features</b>								
Controls	Microprocessor		Microprocessor		Microprocessor		Microprocessor	
Low Ambient Control	Equipped		Equipped		Equipped		Equipped	
Wireless Remote Controller	Included		Included		Included		Included	
Wired Remote Controller (Optional)	CZ-RD516C-1		CZ-RD516C-1		CZ-RD516C-1		CZ-RD516C-1	
Fan Speeds	5 Speeds + Auto		5 Speeds + Auto		5 Speeds + Auto		5 Speeds + Auto	
Timer	24hr Program		24hr Program		24hr Program		24hr Program	
Air Deflection	Horizontal	Manual	Manual	Automatic	Automatic	Automatic	Automatic	Automatic
	Vertical	Automatic	Automatic	Automatic	Automatic	Automatic	Automatic	Automatic
Air Filter	Washable + Anti Microbial Filter		Washable + Anti Microbial Filter		Washable + Anti Microbial Filter		Washable + Anti Microbial Filter	
Refrigerant	R-410A		R-410A		R-410A		R-410A	
Refrigerant control	Electric Expansion Valve		Electric Expansion Valve		Electric Expansion Valve		Electric Expansion Valve	
Operation Sound	In(Hi / Lo / Q-Lo)	dB-A	40 / 25 / 20	43 / 28 / 20	47/39/36	48/40/37	51	51
	Outdoor(Hi)	dB-A	47	48	---	---	---	---
Refrigerant Piping	Type	inches	Flare	Flare	Flare	Flare	Flare	Flare
	Discharge	inches	1/4"	1/4"	1/4"	1/4"	3/8"	3/8"
	Suction	inches	3/8"	1/2"	1/2"	5/8"	5/8"	5/8"
Refrigerant Pipe Length	FL	ft.	Max. 66	Max. 66	Max. 100	Max. 131	Max. 164	Max. 164
Elevation Difference*	Outdoor Above	FL	Max. 49	Max. 49	Max. 49	Max. 49	Max. 100	Max. 100
	Outdoor Below	FL	Max. 49	Max. 49	Max. 49	Max. 49	Max. 50	Max. 50
<b>Dimensions &amp; Weight</b>								
Height	inches	11-7/16"	21-9/32"	11-7/16"	21-9/32"	11-7/16"	31-5/16"	11-7/16"
Width	inches	34-9/32"	30-23/32"	34-9/32"	30-23/32"	42-5/32"	34-15/32"	42-5/32"
Depth	inches	8-1/16"	11-13/32"	8-1/16"	11-13/32"	9-9/32"	12-5/8"	12-5/8"
Net Weight	Lbs.	20.0	82.0	20.0	82.0	26.0	132.0	26.0

\* This is maximum elevation difference when the indoor unit is located above the outdoor unit. (Refer to the table on the P.34 in the catalog for more detail.)

Model No.	26PSK1U6		KS30NKUA		KS36NKUA	
	Indoor Unit S-26PK1U6	Outdoor Unit U-26PS1U6	Indoor Unit CS-KS30NKU	Outdoor Unit CU-KS30NKUA	Indoor Unit CS-KS36NKU	Outdoor Unit CU-KS36NKUA
<b>Performance &amp; Electrical Ratings</b>						
Capacity	Cooling Btu/h	25,200 (9,500-25,200)	30,600 (10,900-30,600)	34,000 (10,900-34,000)		
	Heating Btu/h	---	---	---		
Moisture Removal	High Pints/H	8.1	9.57	10.64		
Dry Air Flow	Hi / Med / Low CFM	559 / 475 / 390	630 / 530 / 412	630 / 530 / 412		
SEER	Cooling	14.9	16.0	16.0		
EER	Cooling	8.9	9.3	8.5		
HSPF	Heating	---	---	---		
Power Supply	V, Phase, Hz	230 / 208V, 1PH, 60Hz	230 / 208V, 1PH, 60Hz	230 / 208V, 1PH, 60Hz		
Running Amps	Cooling A	15.3 / 16.9	16.5 / 18	20 / 21.9		
	Heating A	---	---	---		
Power Input	Cooling W	2,840 / 2,840	3,290	4,000		
	Heating W	---	---	---		
Back-up Heater	kW	---	---	---		
Fuse or Circuit Breaker Capacity	A	15	30	35	45	
<b>Features</b>						
Controls	Microprocessor		Microprocessor		Microprocessor	
Low Ambient Control	Built-in 0°F		Built-in 0°F		Built-in 0°F	
Wireless Remote Controller	Included		Included		Included	
Wired Remote Controller (Optional)	CZ-RTC2		CZ-RD515U & CZ-RC515UA		CZ-RD515U & CZ-RC515UA	
Fan Speeds	Hi / Me / Lo & Auto		Hi / Me / Lo & Auto		Hi / Me / Lo & Auto	
Timer	24-hr Program		1hr OFF and 24-hr Program		1hr OFF and 24-hr Program	
Air Deflection	Horizontal	Manual	Manual	Automatic	Automatic	Automatic
	Vertical	Automatic	Automatic	Automatic	Automatic	Automatic
Air Filter	Washable		Washable		Washable	
Refrigerant	R-410A		R-410A		R-410A	
Refrigerant control	Electric Expansion Valve		Electric Expansion Valve		Electric Expansion Valve	
Operation Sound	In(Hi / Me / Lo / Q-Lo)	dB-A	48 / 42 / 38	49 / 44 / 39	49 / 44 / 39	55
	Outdoor(Hi)	dB-A	49	55	55	55
Refrigerant Piping	Type	inches	Flare	Flare	Flare	Flare
	Discharge	inches	3/8"	3/8"	3/8"	3/8"
	Suction	inches	5/8"	5/8"	5/8"	5/8"
Refrigerant Pipe Length	FL	ft.	Max. 165	Max. 164	Max. 164	Max. 164
Elevation Difference*	Outdoor Above	FL	Max. 100	Max. 100	Max. 100	Max. 100
	Outdoor Below	FL	Max. 50	Max. 50	Max. 50	Max. 50
<b>Dimensions &amp; Weight</b>						
Height	inches	12-63/64"	30-23/32"	11-3/16"	35-13/16"	11-3/16"
Width	inches	44-7/8"	37"	41-15/16"	37-1/3"	41-15/16"
Depth	inches	8-31/32"	13-3/8"	9-1/16"	13-3/8"	13-3/8"
Net Weight	Lbs.	40.0	128.0	32	183	32

This is maximum elevation difference when the indoor unit is located above the outdoor unit. (Refer to the table on the P.34 in the catalog for more detail.)

# RAC Multi-System Indoor Units

S/E Series

The multi-system type allows a single outdoor unit to be connected to 2 indoor units. It also solves the problem of limited installation space and does not clutter the exterior of your home.



CS-S9NKUW-1 / CS-S12NKUW-1

CS-E9NKUAW / CS-E12NKUAW

CS-ME7QKUA



Wireless Remote Controller "Included" with each indoor



Wired Remote Controller (CZ-RD516C-1) (Optional)



## Indoor Unit: Wall Mounted Type

Model No.	Cooling Only	
	CS-S9NKUW-1	CS-S12NKUW-1
Power Source	230V / 208V, 1PH, 60Hz	
Running Ampere	A	4.1 / 4.5
Power Input	W	850
Capacity	Cooling Btu/h	9,600
Moisture Removal	High Pints/H	1.1
Unit Dimensions (HxWxD)	inch 11-7/16" x 34-9/32" x 8-1/16"	
Net Weight	Lbs.	9.0
Air Circulation (High)	Cooling CFM	400
Operating Sound (H/L)	Cooling dB-A	40 / 25 / 20
	Heating dB-A	---
Refrigerant Tube Diameter	Discharge inch	1/4"
	Suction inch	3/8"
Adapters required	N / A	
Elevation Difference*	Outdoor Above Ft.	Max. 49
	Outdoor Below Ft.	Max. 49

Model No.	Heat Pump		
	CS-ME7QKUA	CS-E9NKUAW	CS-E12NKUAW
Power Source	230V / 208V, 1PH, 60Hz		
Running Ampere	2.5 / 2.8	3.1 / 3.5	4.7 / 5.2
Power Input	W	500(340-810) 740(300-1,230)	1,000(250-1,150) 1,300(200-1,710)
Capacity	Cooling Btu/h	6,900(4,100-9,900)	8,500(4,100-10,200)
	Heating Btu/h	10,900(4,100-14,000)	11,200(4,100-14,100)
Moisture Removal	High Pints/H	0.8	1.2
Unit Dimensions (HxWxD)	inch 11-7/16" x 34-9/32" x 8-1/16"		
Net Weight	Lbs.	9.0	9.0
Air Circulation (High)	Cooling CFM	390	395
	Heating CFM	425	475
Operating Sound	Cooling dB-A	39/25	43 / 28 / 20
	Heating dB-A	41/29	42 / 29 / 26
Refrigerant Tube Diameter	Discharge inch	1/4"	1/4"
	Suction inch	3/8"	1/2"
Adapters required	N / A		
Elevation Difference*	Outdoor Above Ft.	Max. 49	Max. 49
	Outdoor Below Ft.	Max. 49	Max. 49

\* This is maximum elevation difference when the indoor unit is located above the outdoor unit. (Refer to the table on the P.34 in the catalog for more detail.)

# RAC Multi-System Outdoor Units

For **2** Rooms



Blue Fin Condenser



CU-2S18NBU-1 / CU-2E18NBU

Model No.	CU-2S18NBU-1		CU-2E18NBU	
	Cooling		Cooling	Heating
Capacity	16,700 Btu/h		16,700	20,200
Air Circulation	High	CFM	1,313	1,313
Number of Connectable Indoor Units	2		2	
SEER	Cooling		18.0	18.0
EER	Cooling		11.5	11.5
HSPF	Heating		---	8.8
Electrical Rating				
Power Supply	V, Phase, Hz	230V / 208V, 1PH, 60Hz		230V / 208V, 1PH, 61Hz
Running Ampere	A	6.9 / 7.6	6.9 / 7.6	8.1 / 9.0
Power Input	W	1,450	1,450	1,850
Maximum Fuse Size	Amps	25	25	
Features				
Controls	Microprocessor		Microprocessor	
Fan Speeds	Auto		Auto	
Compressor	DC Inverter		DC Inverter	
Refrigerant / Amount Charged at Shipment	R-410A / 67.8 Oz		R-410A / 67.8 Oz	
Refrigerant Control	Electric Expansion Valve		Electric Expansion Valve	
Operation Sound	Hi	dB-A	48	49
Refrigerant Tubing Connections	Type		Flare	
Max. Allowable Tubing Length	Ft.		Max.164 (82' per unit)	
Refrigerant Tube Diameter	Discharge	inch	1/4"	1/4"
	Suction	inch	3/8"	3/8"
Dimensions & Weight				
Unit Dimensions	H x W x D	inch	31-5/16" x 34-15/32" (+3-3/4) x 12-5/8"	
Net Weight	Lbs.	152	152	

## CU-2S18NBU-1 & CU-2E18NBU-Cooling

Indoor unit combinations	Cooling Capacity(BTU/h)				Input Power (W)		Current, 208V (A)	Current, 230V (A)	Moisture Removal Volume pt/h	
	Room A	Room B	Total	min - max	Rating	min - max				
1 Room	CS-ME7QKUA	6,900	---	6,900	6,100 - 9,900	500	340 - 810	2.8	2.5	0.8
	CS-S9NKUW-1 / CS-E9NKUAW	9,600	---	9,600	6,200 - 11,200	850	390 - 1,020	4.5	4.1	1.1
	CS-S12NKUW-1* / CS-E12NKUAW*	10,900	---	10,900	6,300 - 12,800	1,000	390 - 1,230	5.2	4.7	1.3
2 Room	CS-ME7QKUA + CS-MECS-ME7QKUA	6,900	6,900	13,800	6,600 - 16,200	1,050	390 - 1,400	5.5	5.0	0.8 + 0.8
	CS-ME7QKUA + CS-S9NKUW-1	6,900	9,600	16,500	7,000 - 19,600	1,500	390 - 1,970	7.8	7.1	0.8 + 1.1
	CS-ME7QKUA + CS-S12NKUW-1	6,500	10,200	16,700	7,100 - 20,000	1,500	390 - 1,970	7.8	7.1	0.8 + 1.3
	CS-S9NKUW-1 / CS-E9NKUAW + CS-S9NKUW-1 / CS-E9NKUAW	8,350	8,350	16,700	7,100 - 20,000	1,450	390 - 1,920	7.6	6.9	1.1 + 1.1
	CS-S9NKUW-1 / CS-E9NKUAW + CS-S12NKUW-1* / CS-E12NKUAW*	7,800	8,900	16,700	7,200 - 20,000	1,450	390 - 1,870	7.6	6.9	1.1 + 1.3
	CS-S12NKUW-1* / CS-E12NKUAW* + CS-S12NKUW-1* / CS-E12NKUAW*	8,350	8,350	16,700	7,200 - 20,000	1,450	390 - 1,840	7.6	6.9	1.3 + 1.3

## CU-2E18NBU-Heating

Indoor unit combinations	Heating Capacity(BTU/h)				Input Power (W)		Current, 208V (A)	Current, 230V (A)	Moisture Removal Volume pt/h	
	Room A	Room B	Total	min - max	Rating	min - max				
1 Room	CS-ME7QKUA	10,900	---	10,900	4,100 - 14,000	740	300 - 1,230	4.1	3.7	---
	CS-E9NKUAW	13,700	---	13,700	6,400 - 15,700	1,150	440 - 1,450	5.9	5.4	---
	CS-E12NKUAW	15,300	---	15,300	6,500 - 17,500	1,300	440 - 1,630	6.6	6.0	---
2 Room	CS-ME7QKUA + CS-ME7QKUA	10,100	10,100	20,200	7,100 - 23,200	1,850	420 - 2,240	9.0	8.1	---
	CS-ME7QKUA + CS-E9QKUA	8,400	11,800	20,200	7,000 - 23,800	1,850	420 - 2,290	9.0	8.1	---
	CS-ME7QKUA + CS-E12QKUA	7,700	12,500	20,200	7,100 - 24,200	1,850	420 - 2,310	9.0	8.1	---
	CS-E9NKUAW + CS-E9NKUAW	10,100	10,100	20,200	7,100 - 24,600	1,850	420 - 2,310	9.0	8.1	---
	CS-E9NKUAW + CS-E12NKUAW*	9,400	10,800	20,200	7,200 - 24,600	1,850	420 - 2,290	9.0	8.1	---
CS-E12NKUAW* + CS-E12NKUAW*	10,100	10,100	20,200	7,200 - 24,600	1,850	420 - 2,290	9.0	8.1	---	

\*For CS-S12NKUW-1/CS-E12NKUAW, the pipe size reducer CZ-MA1P must be used when connecting with multi-zone outdoor unit.



# RAC Multi-System Heat Pump

## Advantages of New Multi-Split Inverter System

Connectable from 2 to 5 Indoor units. System 5 allows single outdoor unit to be connected to 2-5 indoor units. It solves the problem of limited installation space does not clutter the exterior of your home.

Up to **5** Rooms

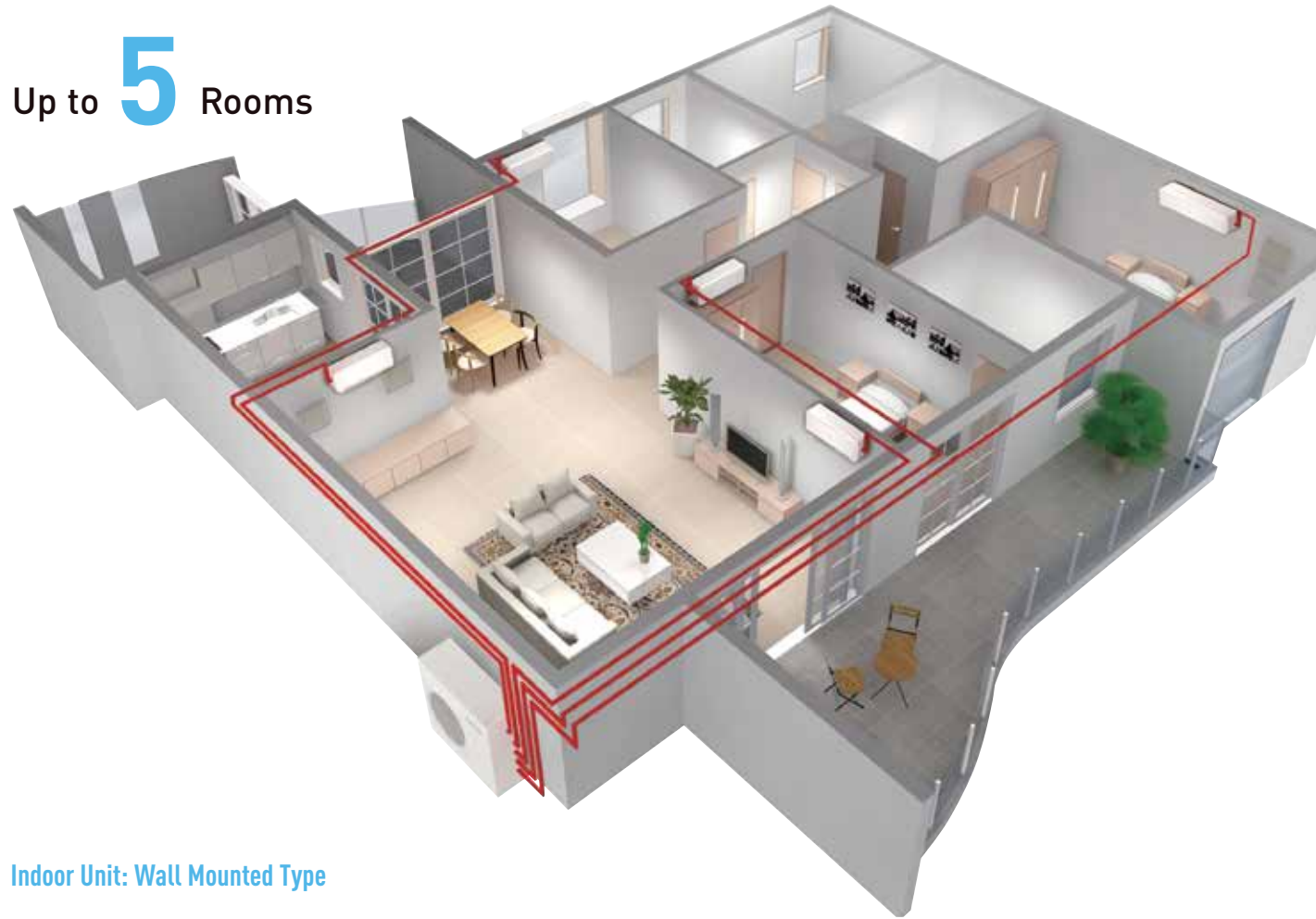

## Indoor Unit: Wall Mounted Type

Model No.	NEW	CS-ME7QKUA	CS-E9NKUAW	CS-E12NKUAW	CS-E18NKUA	CS-E24NKUA
<b>Performance &amp; Electrical Ratings</b>						
Capacity	Cooling	Btu/h 6,900 (6,100-9,900)	8,600 (6,100-9,900)	10,900 (6,100-13,000)	17,100 (6,500-19,400)	24,000 (6,800-24,600)
	Heating	Btu/h 10,900 (4,100-14,000)	12,300 (4,100-14,700)	15,300 (4,100-19,800)	23,400 (4,100-23,600)	29,600 (4,800-31,400)
Moisture Removal	High	Pints/H 0.8	1.1	1.3	2.1	3.2
	Dry Air Flow	High	CFM 425	430	475	680
Power Supply	V, Phase, Hz	230/208V, 1PH, 60Hz	230/208V, 1PH, 60Hz	230/208V, 1PH, 60Hz	230/208V, 1PH, 60Hz	230/208V, 1PH, 60Hz
Running Amps	Cooling	A 2.5/2.8	3.2/3.5	3.9/4.3	7.2 / 8.0	11.3 / 12.5
	Heating	A 3.7/4.1	4.7/5.2	6.0/6.6	9.7 / 10.7	11.8 / 13.0
Power Input	Cooling	W 500 (340-810)	630 (340-810)	800 (340-1,360)	1,550 (340-2,130)	2,490 (370-2,770)
	Heating	W 740 (300-1,230)	940 (300-1,230)	1,230 (300-2,100)	2,100 (300-2,520)	2,550 (680-2,720)
Operation Sound [Hi / Me / Lo / O-Lo]	Cooling	39 / 33 / 25 / 22	40 / 33 / 25 / 22	43 / 37 / 28 / 25	47 / 43 / 39 / 36	48 / 44 / 40 / 37
	Heating	41 / 38 / 29 / 26	42 / 38 / 29 / 26	44 / 40 / 35 / 32	47 / 42 / 39 / 36	48 / 44 / 40 / 37
Elevation Difference*	Outdoor Above	ft Max. 49	Max. 49	Max. 49	Max. 49	Max. 49
	Outdoor Below	ft Max. 47	Max. 47	Max. 47	Max. 47	Max. 47
Refrigerant Tube Diameter	Discharge	inches 1/4"	1/4"	1/4"	1/4"	1/4"
	Suction	inches 3/8"	3/8"	3/8"	3/8"	3/8"
Adapters Required		N/A	N/A	CZ-MA1P Adapter - Indoor Unit	CZ-MA1P Adapter - Indoor Unit	CZ-MA3P Adapter - Indoor Unit CZ-MA2P - Outdoor Unit
<b>Dimensions &amp; Weight</b>						
Height	inches	11-7/16"	11-7/16"	11-7/16"	11-7/16"	11-7/16"
Width	inches	34-9/32"	34-9/32"	34-9/32"	42-5/32"	42-5/32"
Depth	inches	8-1/16"	8-1/16"	8-1/16"	9-9/32"	9-9/32"
Net Weight	lb	20.0	20.0	20.0	26.0	26.0

Caution: All field installed tubing must be compliant to refrigerant 410a.

\* A minimum of 2 indoor units must be connected.

\* This is maximum elevation difference when the indoor unit is located above the outdoor unit. (Refer to the table on the back of the catalog)

# RAC Multi-System Heat Pump

## CS-ME7QKUA / CS-E9NKUAW / CS-E12NKUAW



## CS-E18NKUA / CS-E24NKUA



**INVERTER**

**Blue Fin Condenser**

**New**



Wireless Remote Controller (Standard)



Wired Remote Controller CZ-RD516-1 (Optional)

## Tubing Length

Outdoor Tube Size	Narrow	Inches	1/4"
	Wide	Inches	3/8"
Maximum length of tubing between In / Outdoor		ft	82/unit (262 total)
Maximum Elevation difference between In / Outdoor	Above	ft	49
	Below	ft	47
Maximum Length(ft) of Tubing at shipment (System)*	Above	ft	138
	Below	ft	138
Required Additional Refrigerant		Oz/ft	R410a 0.2
Insulation			Both tubes

\* It is possible to have a combination of wall-mounted models (CS-ME7QKUA, CS-E9NKUAW, E12NKUAW, CS-E18NKUA, E24NKUA) for the (CU-5E36QBU).

\* A minimum of 2 indoor units must be connected.

\* No additional refrigerant needed up to 138 ft. of combined tubing.

## Specifications

Model No.	CU-5E36QBU	
Performance	Cooling	Heating
	Capacity	Rated (min-max) Btu/h 36,000 (9,900-39,000)
Air Circulation	High CFM	2,475
Number of Connectable Indoor Units		2 - 5
SEER	Cooling	18.5
EER	Cooling	9.60
HSPF	Heating	10.0
<b>Electrical Rating</b>		
Power Supply	V, Phase, Hz	230V / 208V, 1PH, 60Hz
Running Ampere	A	17.2 / 19.0
Power Input	W	3,750 (550-3,860) / 2,900 (530-4,240)
Maximum Fuse Size	Amps	45A
<b>Features</b>		
Controls	Microprocessor	
Compressor	DC Inverter	
Refrigerant / Amount Charged at Shipment	Type/oz	R-410A / 120.0 oz
Refrigerant Control	Electric Expansion Valve	
Operation Sound	Hi	dB-A 55
Refrigerant Tubing Connections	Type	Flare
Max. Allowable Tubing Length	ft	82 (per Unit) 262 (per System) with additional refrigerant
Refrigerant Tube Diameter	Discharge	inches 1/4" x 5
	Suction	inches 3/8" x 5
Adapters Required	CZ-MA2P - Outdoor Unit (When connected to CS-24NKUA)	
<b>Dimensions &amp; Weight</b>		
Unit Dimensions	H x W x D	inches 39-11/32" x 37-1/32" x 13-13/32"
Net Weight	lb	183

\* Test condition based on AHRI 210/240

\* When pipes are not extended from the chargeless pipe length, the required amount of refrigerant is already in the unit.

\* Use CZ-MA2P when connecting with CS-E24NKUA (3/8" to 1/2")

# RAC Multi-Combination Tables Heat Pump

## CU-5KE36QU 230V

	Indoor Unit Combination	Indoor Unit Capacity (BTU/h)																						
		COOLING					HEATING					Total Performance												
		Room A	Room B	Room C	Room D	Room E	Room A	Room B	Room C	Room D	Room E	Capacity	Min.	Max.	Capacity	Min.	Max.							
2-room Operation	6,900 + 8,600	= 15,500	6,844	8,556								15,400	( 9,900 - 19,800 )	9,244	11,556						20,800	( 8,200 - 28,000 )		
	6,900 + 10,900	= 17,800	6,846	10,954								17,800	( 9,900 - 19,800 )	9,077	14,523						23,600	( 8,200 - 29,400 )		
	6,900 + 17,100	= 24,000	6,857	17,143								24,000	( 9,900 - 28,000 )	8,743	21,857						30,600	( 8,200 - 37,600 )		
	6,900 + 24,000	= 30,900	6,844	23,956								30,800	( 9,900 - 35,400 )	8,089	28,311						36,400	( 8,900 - 44,500 )		
	8,600 + 8,600	= 17,200	8,600	8,600								17,200	( 9,900 - 19,800 )	11,100	11,100						22,200	( 8,200 - 29,400 )		
	8,600 + 10,900	= 19,500	8,553	10,947								19,500	( 9,900 - 22,800 )	10,877	13,923						24,800	( 8,200 - 34,400 )		
	8,600 + 17,100	= 25,700	8,533	17,067								25,600	( 9,900 - 30,000 )	10,667	21,333						32,000	( 8,200 - 37,600 )		
	8,600 + 24,000	= 32,600	8,579	24,021								32,600	( 9,900 - 36,200 )	9,947	27,853						37,800	( 8,900 - 44,500 )		
	10,900 + 10,900	= 21,800	10,900	10,900								21,800	( 9,900 - 24,600 )	13,800	13,800						27,600	( 8,200 - 37,600 )		
	10,900 + 17,100	= 28,000	10,927	17,073								28,000	( 9,900 - 32,000 )	13,580	21,220						34,800	( 8,200 - 40,500 )		
	10,900 + 24,000	= 34,900	10,918	23,882								34,800	( 9,900 - 37,600 )	11,859	25,941						37,800	( 8,900 - 47,000 )		
	17,100 + 17,100	= 34,200	17,100	17,100								34,200	( 9,900 - 37,600 )	18,900	18,900						37,800	( 8,200 - 47,000 )		
17,100 + 24,000	= 41,100	15,000	21,000								36,000	( 9,900 - 37,600 )	15,750	22,050						37,800	( 8,900 - 47,000 )			
24,000 + 24,000	= 48,000	18,000	18,000								36,000	( 9,900 - 37,600 )	18,900	18,900						37,800	( 9,500 - 47,000 )			
3-room Operation	6,900 + 6,900 + 6,900	= 20,700	6,867	6,867	6,867							20,600	( 9,900 - 27,600 )	9,867	9,867	9,867						29,600	( 11,600 - 42,000 )	
	6,900 + 6,900 + 8,600	= 22,400	6,892	6,892	8,616							22,400	( 9,900 - 27,600 )	9,415	9,415	11,770						30,600	( 11,600 - 42,000 )	
	6,900 + 6,900 + 10,900	= 24,700	6,833	6,833	10,934							24,600	( 9,900 - 27,600 )	9,278	9,278	14,844						33,400	( 11,600 - 42,000 )	
	6,900 + 6,900 + 17,100	= 30,900	6,844	6,844	17,112							30,800	( 9,900 - 33,800 )	8,400	8,400	21,000						37,800	( 11,600 - 46,500 )	
	6,900 + 6,900 + 24,000	= 37,800	6,545	6,545	22,910							36,000	( 9,900 - 38,000 )	6,873	6,873	24,054						37,800	( 11,600 - 47,000 )	
	6,900 + 8,600 + 8,600	= 24,100	6,858	8,571	8,571							24,000	( 9,900 - 27,600 )	9,142	11,429	11,429						32,000	( 11,600 - 42,000 )	
	6,900 + 8,600 + 10,900	= 26,400	6,857	8,571	10,972							26,400	( 9,900 - 27,600 )	9,039	11,299	14,462						34,800	( 11,600 - 44,000 )	
	6,900 + 8,600 + 17,100	= 32,600	6,863	8,579	17,158							32,600	( 9,900 - 35,800 )	7,958	9,947	19,895						37,800	( 11,600 - 46,500 )	
	6,900 + 8,600 + 24,000	= 39,500	6,261	7,826	21,913							36,000	( 9,900 - 38,000 )	6,574	8,217	23,009						37,800	( 11,600 - 47,000 )	
	6,900 + 10,900 + 10,900	= 28,700	6,858	10,971	10,971							28,800	( 9,900 - 31,400 )	8,952	14,324	14,324						37,600	( 11,600 - 44,000 )	
	6,900 + 10,900 + 17,100	= 34,900	6,823	10,918	17,059							34,800	( 9,900 - 38,000 )	7,412	11,859	18,529						37,800	( 11,600 - 46,500 )	
	6,900 + 10,900 + 24,000	= 41,800	5,901	9,443	20,656							36,000	( 9,900 - 38,000 )	6,196	9,915	21,689						37,800	( 11,600 - 47,000 )	
	6,900 + 17,100 + 17,100	= 41,100	6,000	15,000	15,000							36,000	( 9,900 - 38,000 )	6,300	15,750	15,750						37,800	( 11,600 - 47,000 )	
	6,900 + 17,100 + 24,000	= 48,000	5,143	12,857	18,000							36,000	( 9,900 - 38,000 )	5,400	13,500	18,900						37,800	( 11,600 - 48,000 )	
	6,900 + 24,000 + 24,000	= 54,900	4,500	15,750	15,750							36,000	( 9,900 - 38,000 )	4,724	16,538	16,538						37,800	( 11,600 - 49,000 )	
	8,600 + 8,600 + 8,600	= 25,800	8,600	8,600	8,600							25,800	( 9,900 - 27,600 )	11,000	11,000	11,000						33,000	( 11,600 - 42,000 )	
	8,600 + 8,600 + 10,900	= 28,100	8,598	8,598	11,004							28,200	( 9,900 - 31,400 )	10,915	10,915	13,970						35,800	( 11,600 - 44,000 )	
	8,600 + 8,600 + 17,100	= 34,300	8,550	8,550	17,100							34,200	( 9,900 - 38,000 )	9,450	9,450	18,900						37,800	( 11,600 - 46,500 )	
	8,600 + 8,600 + 24,000	= 41,200	7,500	7,500	21,000							36,000	( 9,900 - 38,000 )	7,875	7,875	22,050						37,800	( 11,600 - 47,000 )	
	8,600 + 10,900 + 10,900	= 30,400	8,540	10,930	10,930							30,400	( 9,900 - 33,800 )	10,618	13,591	13,591						37,800	( 11,600 - 46,500 )	
	8,600 + 10,900 + 17,100	= 36,600	8,411	10,766	16,823							36,000	( 9,900 - 38,000 )	8,831	11,305	17,664						37,800	( 11,600 - 47,000 )	
	8,600 + 10,900 + 24,000	= 43,500	7,086	9,071	19,843							36,000	( 9,900 - 38,000 )	7,441	9,524	20,835						37,800	( 11,600 - 48,000 )	
	8,600 + 17,100 + 17,100	= 42,800	7,200	14,400	14,400							36,000	( 9,900 - 38,000 )	7,560	15,120	15,120						37,800	( 11,600 - 47,000 )	
	8,600 + 17,100 + 24,000	= 49,700	6,207	12,414	17,379							36,000	( 9,900 - 38,000 )	6,517	13,034	18,249						37,800	( 11,600 - 48,000 )	
8,600 + 24,000 + 24,000	= 56,600	5,454	15,273	15,273							36,000	( 9,900 - 38,000 )	5,728	16,036	16,036						37,800	( 11,600 - 49,000 )		
10,900 + 10,900 + 10,900	= 32,700	10,933	10,933	10,933							32,800	( 9,900 - 35,800 )	12,600	12,600	12,600						37,800	( 11,600 - 46,500 )		
10,900 + 10,900 + 17,100	= 38,900	10,105	10,105	15,790							36,000	( 9,900 - 38,000 )	10,611	10,611	16,578						37,800	( 11,600 - 47,000 )		
10,900 + 10,900 + 24,000	= 45,800	8,597	8,597	18,806							36,000	( 9,900 - 38,000 )	9,027	9,027	19,746						37,800	( 11,600 - 48,000 )		
10,900 + 17,100 + 17,100	= 45,100	8,728	13,636	13,636							36,000	( 9,900 - 38,000 )	9,164	14,318	14,318						37,800	( 11,600 - 48,000 )		
10,900 + 17,100 + 24,000	= 52,000	7,579	11,842	16,579							36,000	( 9,900 - 38,000 )	7,958	12,434	17,408						37,800	( 11,600 - 49,000 )		
10,900 + 24,000 + 24,000	= 58,900	6,698	14,651	14,651							36,000	( 9,900 - 38,000 )	7,032	15,384	15,384						37,800	( 11,600 - 49,000 )		
17,100 + 17,100 + 17,100	= 51,300	12,000	12,000	12,000							36,000	( 9,900 - 38,000 )	12,600	12,600	12,600						37,800	( 11,600 - 49,000 )		
17,100 + 17,100 + 24,000	= 58,200	10,588	10,588	14,824							36,000	( 9,900 - 38,000 )	11,118	11,118	15,564						37,800	( 11,600 - 49,000 )		
4-room Operation	6,900 + 6,900 + 6,900 + 6,900	= 27,600	6,850	6,850	6,850	6,850						27,400	( 9,900 - 36,400 )	9,450	9,450	9,450	9,450						37,800	( 11,600 - 48,500 )
	6,900 + 6,900 + 6,900 + 8,600	= 29,300	6,871	6,871	6,871	8,587						29,200	( 9,900 - 36,400 )	8,894	8,894	8,894	11,118						37,800	( 11,600 - 48,500 )
	6,900 + 6,900 + 6,900 + 10,900	= 31,600	6,870	6,870	6,870	10,990						31,600	( 9,900 - 36,400 )	8,217	8,217	8,217	13,149						37,800	( 11,600 - 48,500 )
	6,900 + 6,900 + 6,900 + 17,100	= 37,800	6,545	6,545	6,545	16,365						36,000	( 9,900 - 36,400 )	6,873	6,873	6,873	17,181						37,800	( 11,600 - 48,500 )
	6,900 + 6,900 + 6,900 + 24,000	= 44,700	5,538	5,538	5,538	19,386						36												



# RAC Multi-System Indoor Units

KS/KE Series

## Fits with Various Sizes of Rooms and Lifestyle

The multi-system type allows a single outdoor unit to be connected to 2 to 4 indoor units. It also solves the problem of limited installation space and does not clutter the exterior of your home.



CS-MKS7NKU / CS-MKS9NKU / CS-MKS12NKU

CS-MKS18NKU / CS-MKS24NKU

CS-MKE7NKU / CS-MKE9NKU / CS-MKE12NKU

CS-MKE18NKU / CS-MKE24NKU



Wireless Remote Controller (Included) with each indoor



Wired Remote Controller CZ-RD515U (Optional)



## Indoor Unit: Wall Mounted Type

Model No.		CS-MKS7NKU	CS-MKS9NKU	CS-MKS12NKU	CS-MKS18NKU	CS-MKS24NKU
Power Source		230V / 208V, 1 PH, 60 Hz				
Running Ampere	A	0.11 / 0.12	0.15 / 0.17	0.15 / 0.17	0.15 / 0.17	0.20 / 0.22
Power Input	W	25	35	35	35	45
Capacity	Cooling Btu/h	7,500	9,000	11,900	17,500	24,200
Moisture Removal	High Pints/H	2.77	3.40	4.26	4.89	4.89
Unit Dimensions (HxWxD)	inch	11"-7/32" x 32"-15/32" x 7"-7/16"			11"-23/32" x 41"-15/16" x 8"-19/32"	
Net Weight	Lbs.	19.8	19.8	19.8	26.5	26.5
Air Circulation (H.M.L.)	Cooling CFM	241 / 224 / 212	259 / 241 / 212	282 / 259 / 218	500 / 447 / 377	541 / 500 / 435
Operating Sound (H/L)	Cooling dB-A	33 / 23	34 / 23	36 / 25	41 / 28	44 / 30
	Heating dB-A	---	---	---	---	---
Refrigerant Tube Diameter	Discharge inch	1/4"	1/4"	1/4"	1/4"	1/4"
	Suction inch	3/8"	3/8"	3/8"	1/2"	5/8"
Elevation Difference*	Outdoor Above Ft.	Max. 50	Max. 50	Max. 50	Max. 50	Max. 50
	Outdoor Below Ft.	Max. 50	Max. 50	Max. 50	Max. 50	Max. 50

Model No.		CS-MKE7NKU	CS-MKE9NKU	CS-MKE12NKU	CS-MKE18NKU	CS-MKE24NKU
Power Source		230V-208V, 1 PH, 60 Hz				
Running Ampere	W	0.11 / 0.12	0.15 / 0.17	0.15 / 0.17	0.15 / 0.17	0.20 / 0.22
Power Input	W	25	35	35	35	45
Capacity	Cooling Btu/h	7,500	9,000	11,900	17,500	24,200
	Heating Btu/h	8,500	12,200	14,300	20,400	29,000
Moisture Removal	High Pints/H	2.77	3.40	4.26	4.89	4.89
Unit Dimensions (HxWxD)	inch	11"-7/32" x 32"-15/32" x 7"-7/16"			11"-23/32" x 41"-15/16" x 8"-19/32"	
Net Weight	Lbs.	19.8	19.8	19.8	26.5	26.5
Air Circulation (H.M.L.)	Cooling CFM	241 / 224 / 212	259 / 241 / 212	282 / 257 / 218	500 / 447 / 377	541 / 481 / 435
	Heating CFM	271 / 241 / 218	282 / 271 / 218	294 / 271 / 218	500 / 447 / 377	541 / 481 / 435
Hi / Me / Lo / Qt	Cooling dB-A	33 / 30 / 27 / 23	34 / 31 / 28 / 23	36 / 33 / 29 / 25	41 / 38 / 34 / 28	44 / 41 / 38 / 30
	Heating dB-A	33 / 30 / 27 / 23	34 / 31 / 28 / 23	34 / 31 / 29 / 25	40 / 37 / 34 / 28	43 / 40 / 37 / 30
Refrigerant Tube Diameter	Discharge inch	1/4"	1/4"	1/4"	1/4"	1/4"
	Suction inch	3/8"	3/8"	3/8"	1/2"	5/8"
Elevation Difference*	Outdoor Above Ft.	Max. 50	Max. 50	Max. 50	Max. 50	Max. 50
	Outdoor Below Ft.	Max. 50	Max. 50	Max. 50	Max. 50	Max. 50

\* This is maximum elevation difference when the indoor unit is located above the outdoor unit. (Refer to the table on the back of the catalog)

# RAC Multi-System Indoor Units

KS/KE Series

## Fits with Various Sizes of Rooms and Lifestyle

The multi-system type allows a single outdoor unit to be connected to 2 to 4 indoor units. It also solves the problem of limited installation space and does not clutter the exterior of your home.



CS-MKS9NB4U / CS-MKS12NB4U / CS-KS18NB4UW

CS-MKE9NB4U / CS-MKE12NB4U / CS-KE18NB4UW



Wireless Remote Controller (Included) with each indoor



Wired Remote Controller CZ-RD515U Wire Kit CZ-RC515U (Optional)

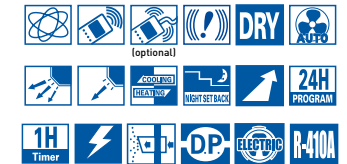

## Indoor Unit: Ceiling Recessed Type

Model No.		CS-MKS9NB4U	CS-MKS12NB4U	CS-KS18NB4UW
Power Source		230V / 208V, 1 PH, 60 Hz		
Running Ampere	A	0.10 / 0.11	0.11 / 0.12	0.15 / 0.16
Power Input	W	16	17	22
Capacity	Cooling Btu/h	9,000	11,900	17,500
Moisture Removal	High Pints/H	3.4	4.26	4.89
Unit Dimensions (HxWxD)	inch	12.5"-16" x 24"-19/32" x 24"-19/32"		
Net Weight	Lbs.	41.3		
Air Circulation (H.M.L.)	Cooling CFM	221 / 206 / 194	235 / 206 / 194	341 / 294 / 253
Operating Sound (H/L)	Cooling dB-A	33 / 32 / 31	34 / 32 / 31	44 / 40 / 36
	Heating dB-A	---	---	---
Refrigerant Tube Diameter	Discharge inch	1/4"	1/4"	1/4"
	Suction inch	3/8"	3/8"	1/2"
Elevation Difference*	Outdoor Above Ft.	Max. 50	Max. 50	Max. 50
	Outdoor Below Ft.	Max. 50	Max. 50	Max. 50

Model No.		CS-MKE9NB4U	CS-MKE12NB4U	CS-KE18NB4UW
Power Source		230V-208V, 1 PH, 60 Hz		
Running Ampere	A	0.10 / 0.11 & 0.12 / 0.13	0.11 / 0.12 & 0.13 / 0.14	0.15 / 0.16 & 0.19 / 0.20
Power Input	W	16 / 18	17 / 19	22 / 27
Capacity	Cooling Btu/h	9,000	11,900	17,500
	Heating Btu/h	12,300	13,600	20,400
Moisture Removal	High Pints/H	3.4	4.26	4.89
Unit Dimensions (HxWxD)	inch	12.5"-16" x 24"-19/32" x 24"-19/32"		
Net Weight	Lbs.	41.3		
Air Circulation (H.M.L.)	Cooling CFM	221 / 206 / 194	235 / 206 / 194	341 / 294 / 253
	Heating CFM	247 / 235 / 224	268 / 247 / 224	383 / 324 / 265
Operating Sound(H/L)	Cooling dB-A	33 / 32 / 31	34 / 32 / 31	44 / 40 / 36
	Heating dB-A	34 / 33 / 32	35 / 34 / 32	44 / 40 / 36
Refrigerant Tube Diameter	Discharge inch	1/4"	1/4"	1/4"
	Suction inch	3/8"	3/8"	1/2"
Elevation Difference*	Outdoor Above Ft.	Max. 50	Max. 50	Max. 50
	Outdoor Below Ft.	Max. 50	Max. 50	Max. 50

\* This is maximum elevation difference when the indoor unit is located above the outdoor unit. (Refer to the table on the back of the catalog)

Connectable from 2 to 3 Indoor Units

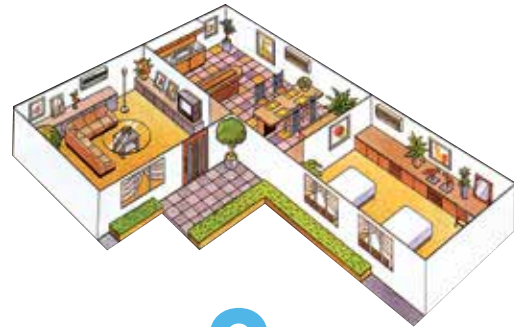

Up to **3** Rooms



**CU-3KS19NBU**  
**CU-3KE19NBU**

Connectable from 2 to 4 Indoor Units



Up to **4** Rooms



**CU-4KS24NBU**  
**CU-4KE24NBU**

**CU-4KS31NBU**  
**CU-4KE31NBU**

## Outdoor Unit

Model No.	CU-3KS19NBU		CU-3KE19NBU	
<b>Performance</b>	Cooling		Cooling	Heating
Capacity	17,000 Btu/h		17,000	23,200
Air Circulation	High	CFM	1,707	1,707
Number of Connectable Indoor Units	2 - 3		2 - 3	2 - 3
SEER	Cooling	18.0	18.0	18.0
EER	Cooling	12.0	12.0	12.0
HSPF	Heating	---	8.8	8.8
<b>Electrical Rating</b>	230V / 208V, 1Ph, 60Hz		230V / 208V, 1Ph, 60Hz	
Power Supply	V, Phase, Hz	230V / 208V, 1Ph, 60Hz	230V / 208V, 1Ph, 60Hz	230V / 208V, 1Ph, 60Hz
Running Ampere	A	6.3 / 7.0	6.3 / 7.0	9.1 / 10.1
Power Input	W	1,420	1,420	2,050
Maximum Fuse Size	Amps	15A	15A	15A
<b>Features</b>	Microprocessor		Microprocessor	
Controls	Auto (Hi, Me, Lo)		Auto (Hi, Me, Lo)	
Fan Speeds	DC Inverter		DC Inverter	
Compressor	R-410A / 6.17		R-410A / 6.17	
Refrigerant / Amount Charged at Shipment	1b.	R-410A / 6.17	R-410A / 6.17	R-410A / 6.17
Refrigerant Control	Electric Expansion Valve		Electric Expansion Valve	
Operation Sound	Hi	50 dB-A	50	52
Refrigerant Tubing Connections	Type	Flare	Flare	Flare
Max. Allowable Tubing Length	Ft	82 (per Unit) 150 (per System) with additional refrigerant	82 (per Unit) 150 (per System) with additional refrigerant	82 (per Unit) 150 (per System) with additional refrigerant
Refrigerant Tube Diameter	Discharge	1/4" x 3	1/4" x 3	1/4" x 3
	Suction	3/8" x 3	3/8" x 3	3/8" x 3
<b>Dimensions &amp; Weight</b>	29-1/8" x 35-7/16" x 12-19/32"		29-1/8" x 35-7/16" x 12-19/32"	
Unit Dimensions	H x W x D	29-1/8" x 35-7/16" x 12-19/32"	29-1/8" x 35-7/16" x 12-19/32"	29-1/8" x 35-7/16" x 12-19/32"
Net Weight	Lbs.	138.9	143.0	143.0

**IMPORTANT** It is not possible to connect an outdoor unit to only a single indoor unit. If operated with only ONE indoor unit installed, the returning refrigerant to the compressor may cause a malfunction.

\* Test Conditions based on AHRI 210/240

## Outdoor Unit

Model No.	CU-4KS24NBU		CU-4KE24NBU		CU-4KS31NBU		CU-4KE31NBU	
<b>Performance</b>	Cooling		Cooling	Heating	Cooling	Heating	Cooling	Heating
Capacity	24,200 Btu/h		22,400	27,200	29,000 / 28,600	30,600	29,000 / 28,600	30,600
Air Circulation	High	CFM	1,707	1,707	1,942	1,942	1,942	1,942
Number of Connectable Indoor Units	2 - 4		2 - 4	2 - 4	2 - 4	2 - 4	2 - 4	2 - 4
SEER	Cooling	18.0	18.0	17.6	17.2	17.2	17.2	17.2
EER	Cooling	10.0	11.5	11.2	11.2	11.2	11.2	11.2
HSPF	Heating	---	8.5	---	9.3	9.3	9.3	9.3
<b>Electrical Rating</b>	230V / 208V, 1Ph, 60Hz		230V / 208V, 1Ph, 60Hz		230V / 208V, 1Ph, 60Hz		230V / 208V, 1Ph, 60Hz	
Power Supply	V, Phase, Hz	230V / 208V, 1Ph, 60Hz	230V / 208V, 1Ph, 60Hz	230V / 208V, 1Ph, 60Hz	230V / 208V, 1Ph, 60Hz	230V / 208V, 1Ph, 60Hz	230V / 208V, 1Ph, 60Hz	230V / 208V, 1Ph, 60Hz
Running Ampere	A	10.7 / 11.9	8.7 / 9.6	10.0 / 11.0	11.4 / 12.6	10.1 / 11.2	11.4 / 12.6	10.1 / 11.2
Power Input	W	2,420	1,950	2,250	2,600 / 2,560	2,300	2,600 / 2,560	2,300
Maximum Fuse Size	Amps	20A	20A	20A	20A	20A	20A	20A
<b>Features</b>	Microprocessor		Microprocessor		Microprocessor		Microprocessor	
Controls	Auto (Hi, Me, Lo)		Auto (Hi, Me, Lo)		Auto (Hi, Me, Lo)		Auto (Hi, Me, Lo)	
Fan Speeds	DC Inverter		DC Inverter		DC Inverter		DC Inverter	
Compressor	R-410A / 6.17		R-410A / 6.17		R-410A / 8.38		R-410A / 8.38	
Refrigerant / Amount Charged at Shipment	1b.	R-410A / 6.17	R-410A / 6.17	R-410A / 6.17	R-410A / 8.38	R-410A / 8.38	R-410A / 8.38	R-410A / 8.38
Refrigerant Control	Electric Expansion Valve		Electric Expansion Valve		Electric Expansion Valve		Electric Expansion Valve	
Operation Sound	Hi	50 dB-A	50	52	53	53	53	55
Refrigerant Tubing Connections	Type	Flare	Flare	Flare	Flare	Flare	Flare	Flare
Max. Allowable Tubing Length	Ft	82 (per Unit) 200 (per System with additional Refrigerant)	82 (per Unit) 200 (per System with additional Refrigerant)	82 (per Unit) 200 (per System with additional Refrigerant)	100 (per Unit) 230 (per System with additional Refrigerant)	100 (per Unit) 230 (per System with additional Refrigerant)	100 (per Unit) 230 (per System with additional Refrigerant)	100 (per Unit) 230 (per System with additional Refrigerant)
Refrigerant Tube Diameter	Discharge	1/4" x 4	1/4" x 4	1/4" x 4	1/4" x 4	1/4" x 4	1/4" x 4	1/4" x 4
	Suction	3/8" x 3 + 1/2" x 1	3/8" x 3 + 1/2" x 1	3/8" x 3 + 1/2" x 1	3/8" x 2 + 1/2" x 2	3/8" x 2 + 1/2" x 2	3/8" x 2 + 1/2" x 2	3/8" x 2 + 1/2" x 2
<b>Dimensions &amp; Weight</b>	29-1/8" x 35-7/16" x 12-19/32"		29-1/8" x 35-7/16" x 12-19/32"		35-1/32" x 35-7/16" x 12-19/32"		35-1/32" x 35-7/16" x 12-19/32"	
Unit Dimensions	H x W x D	29-1/8" x 35-7/16" x 12-19/32"	29-1/8" x 35-7/16" x 12-19/32"	29-1/8" x 35-7/16" x 12-19/32"	35-1/32" x 35-7/16" x 12-19/32"	35-1/32" x 35-7/16" x 12-19/32"	35-1/32" x 35-7/16" x 12-19/32"	35-1/32" x 35-7/16" x 12-19/32"
Net Weight	Lbs.	138.9	143.3	174.2	174.2	181.0	181.0	181.0

**IMPORTANT** It is not possible to connect an outdoor unit to only a single indoor unit. If operated with only ONE indoor unit installed, the returning refrigerant to the compressor may cause a malfunction.

\* Test Conditions based on AHRI 210/240



# RAC Multi-Combination Tables Cooling

Most popular combinations refer to technical manual for complete listing of combinations.

### CU-3KS19NBU/CU-3KE19NBU 230V

	Indoor Unit Combination	Indoor Unit Capacity (BTU/h)	Indoor Unit Capacity (BTU/h)												
			COOLING						HEATING						
			Room A	Room B	Room C	Total Performance			Room A	Room B	Room C	Total Performance			
			Capacity	Min.	Max.	Capacity	Min.	Max.	Capacity	Min.	Max.	Capacity	Min.	Max.	
2-room Operation	7,500 + 7,500	= 15,000	7,500	7,500		15,000	( 6,800 - 17,400 )	8,500	8,500		17,000	( 6,800 - 21,800 )			
	7,500 + 9,000	= 16,500	7,500	9,000		16,500	( 6,800 - 18,600 )	8,525	12,275		20,800	( 7,100 - 24,800 )			
	7,500 + 11,900	= 19,400	6,727	10,673		17,400	( 6,800 - 18,600 )	8,358	14,042		22,400	( 7,100 - 24,800 )			
	7,500 + 17,500	= 25,000	5,520	12,880		18,400	( 7,100 - 18,600 )	7,000	16,800		23,800	( 8,100 - 24,800 )			
	9,000 + 9,000	= 18,000	8,500	8,500		17,000	( 6,800 - 18,600 )	11,600	11,600		23,200	( 7,800 - 24,800 )			
	9,000 + 11,900	= 20,900	7,622	10,078		17,700	( 7,100 - 18,600 )	10,800	12,600		23,400	( 7,800 - 24,800 )			
	9,000 + 17,500	= 26,500	6,317	12,283		18,600	( 7,100 - 18,600 )	9,075	15,125		24,200	( 8,100 - 24,800 )			
3-room Operation	11,900 + 11,900	= 23,800	9,200	9,200		18,400	( 6,800 - 18,600 )	11,900	11,900		23,800	( 7,800 - 24,800 )			
	11,900 + 17,500	= 29,400	7,529	11,071		18,600	( 7,100 - 18,600 )	10,129	14,471		24,600	( 8,100 - 24,800 )			
	7,500 + 7,500 + 7,500	= 22,500	6,000	6,000	6,000	18,000	( 8,500 - 18,600 )	7,800	7,800	7,800	23,400	( 9,200 - 24,800 )			
	7,500 + 7,500 + 9,000	= 24,000	5,750	5,750	6,900	18,400	( 9,800 - 18,600 )	6,919	6,919	9,963	23,800	( 10,200 - 24,800 )			
	7,500 + 7,500 + 11,900	= 26,900	5,186	5,186	8,228	18,600	( 9,800 - 18,600 )	6,576	6,578	11,048	24,200	( 10,900 - 24,800 )			
	7,500 + 7,500 + 17,500	= 32,500	4,292	4,292	10,015	18,600	( 9,800 - 18,600 )	5,636	5,636	13,527	24,800	( 11,600 - 24,800 )			
	7,500 + 9,000 + 9,000	= 25,500	5,471	6,565	6,565	18,600	( 9,800 - 18,600 )	6,237	8,981	8,981	24,200	( 11,600 - 24,800 )			
	7,500 + 9,000 + 11,900	= 28,400	4,912	5,894	7,794	18,600	( 9,800 - 18,600 )	5,971	8,598	10,031	24,600	( 11,600 - 24,800 )			
	7,500 + 9,000 + 17,500	= 34,000	4,103	4,924	9,574	18,600	( 9,800 - 18,600 )	5,124	7,379	12,298	24,800	( 11,600 - 24,800 )			
	7,500 + 11,900 + 11,900	= 31,300	4,457	7,072	7,072	18,600	( 9,800 - 18,600 )	5,688	9,556	9,556	24,800	( 11,600 - 24,800 )			
	9,000 + 9,000 + 9,000	= 27,000	6,200	6,200	6,200	18,600	( 9,800 - 18,600 )	8,267	8,267	8,267	24,800	( 11,600 - 24,800 )			
9,000 + 9,000 + 11,900	= 29,900	5,599	5,599	7,403	18,600	( 9,800 - 18,600 )	7,832	7,832	9,137	24,800	( 11,600 - 24,800 )				
9,000 + 11,900 + 11,900	= 32,800	5,104	6,748	6,748	18,600	( 9,800 - 18,600 )	7,440	8,680	8,680	24,800	( 11,600 - 24,800 )				
11,900 + 11,900 + 11,900	= 35,700	6,200	6,200	6,200	18,600	( 9,800 - 18,600 )	8,267	8,267	8,267	24,800	( 11,600 - 24,800 )				

### CU-4KS24NBU/CU-4KE24NBU

	Indoor Unit Combination	Indoor Unit Capacity (BTU/h)	Indoor Unit Capacity (BTU/h)														
			COOLING							HEATING							
			Room A	Room B	Room C	Room D	Total Performance			Room A	Room B	Room C	Room D	Total Performance			
				Capacity	Min.	Max.	Capacity	Min.	Max.	Capacity	Min.	Max.	Capacity	Min.	Max.		
2-room Operation	7,500 + 7,500	= 15,000	7,500	7,500			15,000	( 6,800 - 17,400 )	8,500	8,500			17,000	( 6,800 - 21,800 )			
	7,500 + 9,000	= 16,500	7,500	9,000			16,500	( 6,800 - 19,700 )	8,500	12,200			20,800	( 7,100 - 25,400 )			
	7,500 + 11,900	= 19,400	7,500	11,900			19,400	( 6,800 - 22,800 )	8,500	14,300			22,800	( 7,100 - 28,200 )			
	7,500 + 17,500	= 25,000	6,720	15,680			22,400	( 7,100 - 23,200 )	8,500	20,400			28,200	( 8,100 - 29,200 )			
	7,500 + 24,200	= 31,700	5,489	17,711			23,200	( 7,100 - 23,200 )	8,500	29,000			29,200	( 8,100 - 29,200 )			
	9,000 + 9,000	= 18,000	9,000	9,000			18,000	( 6,800 - 21,400 )	12,200	12,200			24,400	( 7,800 - 29,000 )			
	9,000 + 11,900	= 20,900	8,612	11,388			20,000	( 6,800 - 23,200 )	12,200	14,300			25,800	( 7,800 - 29,000 )			
	9,000 + 17,500	= 26,500	7,743	15,057			22,800	( 7,100 - 23,200 )	12,200	20,400			28,600	( 8,100 - 29,200 )			
	9,000 + 24,200	= 33,200	6,289	16,911			23,200	( 7,100 - 23,200 )	12,200	29,000			29,200	( 8,100 - 29,200 )			
	11,900 + 11,900	= 23,800	11,200	11,200			22,400	( 6,800 - 23,200 )	14,300	14,300			27,200	( 7,800 - 29,000 )			
	11,900 + 17,500	= 29,400	9,390	13,810			23,200	( 7,100 - 23,200 )	14,300	20,400			29,000	( 8,100 - 29,200 )			
	11,900 + 24,200	= 36,100	7,648	15,552			23,200	( 7,100 - 23,200 )	14,300	29,000			29,200	( 8,100 - 29,200 )			
	17,500 + 17,500	= 35,000	11,600	11,600			23,200	( 7,100 - 23,200 )	20,400	20,400			29,200	( 8,100 - 29,200 )			
3-room Operation	7,500 + 7,500 + 7,500	= 22,500	7,333	7,333	7,333		22,000	( 8,500 - 23,200 )	8,500	8,500	8,500		25,400	( 9,200 - 29,000 )			
	7,500 + 7,500 + 9,000	= 24,000	7,000	7,000	8,400		22,400	( 9,800 - 23,200 )	8,500	8,500	12,200		27,200	( 10,200 - 29,200 )			
	7,500 + 7,500 + 11,900	= 26,900	6,413	6,413	10,175		23,000	( 9,800 - 23,200 )	8,500	8,500	14,300		28,200	( 10,900 - 29,200 )			
	7,500 + 7,500 + 17,500	= 32,500	5,354	5,354	12,492		23,200	( 9,800 - 23,200 )	8,500	8,500	20,400		29,200	( 11,600 - 29,200 )			
	7,500 + 9,000 + 9,000	= 25,500	6,706	8,047	8,047		22,800	( 9,800 - 23,200 )	8,500	12,200	12,200		28,600	( 11,600 - 29,200 )			
	7,500 + 9,000 + 11,900	= 28,400	6,127	7,352	9,721		23,200	( 9,800 - 23,200 )	8,500	12,200	14,300		29,000	( 11,600 - 29,200 )			
	7,500 + 9,000 + 17,500	= 34,000	5,118	6,141	11,941		23,200	( 9,800 - 23,200 )	8,500	12,200	20,400		29,200	( 11,600 - 29,200 )			
	7,500 + 11,900 + 11,900	= 31,300	5,559	8,820	8,820		23,200	( 9,800 - 23,200 )	8,500	14,300	14,300		29,200	( 11,600 - 29,200 )			
	7,500 + 11,900 + 17,500	= 36,900	4,715	7,482	11,003		23,200	( 9,800 - 23,200 )	8,500	14,300	20,400		29,200	( 11,600 - 29,200 )			
	9,000 + 9,000 + 9,000	= 27,000	7,733	7,733	7,733		23,200	( 9,800 - 23,200 )	12,200	12,200	12,200		29,200	( 11,600 - 29,200 )			
	9,000 + 9,000 + 11,900	= 29,900	6,983	6,983	9,233		23,200	( 9,800 - 23,200 )	12,200	12,200	14,300		29,200	( 11,600 - 29,200 )			
	9,000 + 9,000 + 17,500	= 35,500	5,882	5,882	11,437		23,200	( 9,800 - 23,200 )	12,200	12,200	20,400		29,200	( 11,600 - 29,200 )			
	9,000 + 11,900 + 11,900	= 32,800	6,366	8,417	8,417		23,200	( 9,800 - 23,200 )	12,200	14,300	14,300		29,200	( 11,600 - 29,200 )			
	9,000 + 11,900 + 17,500	= 38,400	5,438	7,190	10,573		23,200	( 9,800 - 23,200 )	12,200	14,300	20,400		29,200	( 11,600 - 29,200 )			
	11,900 + 11,900 + 11,900	= 35,700	7,733	7,733	7,733		23,200	( 9,800 - 23,200 )	14,300	14,300	14,300		29,200	( 11,600 - 29,200 )			
	11,900 + 11,900 + 17,500	= 41,300	6,685	6,685	9,831		23,200	( 9,800 - 23,200 )	14,300	14,300	20,400		29,200	( 11,600 - 29,200 )			
	7,500 + 7,500 + 7,500 + 7,500	= 30,000	5,800	5,800	5,800	5,800		23,200	( 9,800 - 23,200 )	7,300	7,300	7,300		29,200	( 11,600 - 29,200 )		
	7,500 + 7,500 + 7,500 + 9,000	= 31,500	5,524	5,524	6,629		23,200	( 9,800 - 23,200 )	6,952	6,952	8,343		29,200	( 11,600 - 29,200 )			
	7,500 + 7,500 + 7,500 + 11,900	= 34,400	5,058	5,058	8,026		23,200	( 9,800 - 23,200 )	6,366	6,366	10,101		29,200	( 11,600 - 29,200 )			
	7,500 + 7,500 + 7,500 + 17,500	= 40,000	4,350	4,350	10,150		23,200	( 9,800 - 23,200 )	5,475	5,475	12,775		29,200	( 11,600 - 29,200 )			
	7,500 + 7,500 + 9,000 + 9,000	= 33,000	5,273	5,273	6,327	6,327		23,200	( 9,800 - 23,200 )	6,636	6,636	7,964		29,200	( 11,600 - 29,200 )		
7,500 + 7,500 + 9,000 + 11,900	= 35,900	4,847	4,847	5,816	7,690		23,200	( 9,800 - 23,200 )	6,100	6,100	7,320		29,200	( 11,600 - 29,200 )			
7,500 + 7,500 + 9,000 + 17,500	= 41,500	4,193	4,193	5,031	9,783		23,200	( 9,800 - 23,200 )	5,277	5,277	6,333		29,200	( 11,600 - 29,200 )			
7,500 + 7,500 + 11,900 + 11,900	= 38,800	4,485	4,485	7,115	7,115		23,200	( 9,800 - 23,200 )	5,644	5,644	6,956		29,200	( 11,600 - 29,200 )			
7,500 + 7,500 + 11,900 + 17,500	= 44,400	3,919	3,919	6,218	9,144		23,200	( 9,800 - 23,200 )	4,932	4,932	7,826		29,200	( 11,600 - 29,200 )			
7,500 + 9,000 + 9,000 + 9,000	= 34,500																

# Ceiling-Suspended Air Conditioners and Heat Pumps

26PST1U6

26PET1U6



Indoor Unit  
S-26PT1U6

36PST1U6 / 42PST1U6

36PET1U6 / 42PET1U6



Indoor Unit  
S-36PT1U6 / S-42PT1U6



Outdoor Unit  
U-26PS1U6 / U-26PE1U6



Wired Remote Controller  
(Included)

Wireless Remote Controller  
(optional)



Outdoor Unit  
U-36PS1U6 / U-36PE1U6



Outdoor Unit  
U-42PS1U6 / U-42PE1U6



Wired Remote Controller  
(Included)

Wireless Remote Controller  
(optional)

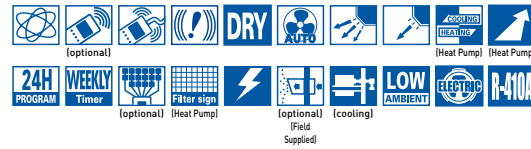

## Quiet Operation

The ceiling-mounted unit is equipped with a highly efficient, multi-blade centrifugal fan that generates a powerful, yet gentle airflow throughout the room. A redesigned aerodynamically tested louver structure minimizes operational sound even at high fan speed.



## Improved Serviceability / Easy Installation

External suspension method. Installation time can be shortened.

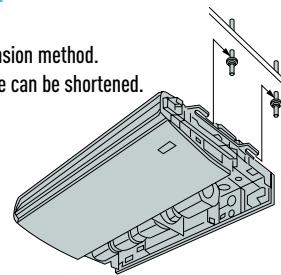

Improved accessibility to electronic components (control box) for servicing.



## Auto-Louver Function Provides Optimum Airflow During Heating or Cooling Operation

Auto-louver function is a standard feature which provides optimum airflow during heating or cooling operation. Angle of louver is automatically set for heating or cooling. For example, when heating with fan speed set to low, the discharge is aimed downward so that warm air reaches the floor. The louver angle can be set to between 4°F above and 80°F below the horizontal in five steps. An auto-sweep function to distribute the airflow over a wide area is also provided. Wind direction is adjusted automatically in both heating and cooling operation. The louver can also be set to swing automatically from F1 to F5 in any operation mode (heat pump type only).

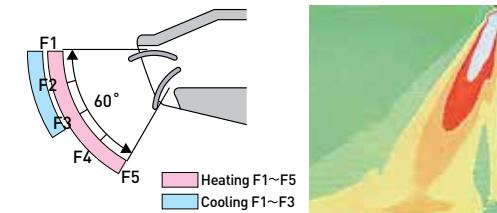

## Fresh Air Intake Capability and Duct Extension

Ceiling-suspended models have the capability of bringing fresh air from outside using an air-intake duct (field supplied).

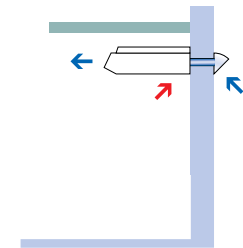

Ceiling - Suspended													
Model No.	Air Conditioners						Heat Pumps						
	26PST1U6		36PST1U6		42PST1U6		26PET1U6		36PET1U6		42PET1U6		
Unit Model No.	Indoor Unit	Outdoor Unit	Indoor Unit	Outdoor Unit	Indoor Unit	Outdoor Unit	Indoor Unit	Outdoor Unit	Indoor Unit	Outdoor Unit	Indoor Unit	Outdoor Unit	
	S-26PT1U6	U-26PS1U6	S-36PT1U6	U-36PS1U6	S-42PT1U6	U-42PS1U6	S-26PT1U6	U-26PE1U6	S-36PT1U6	U-36PE1U6	S-42PT1U6	U-42PE1U6	
<b>Performance &amp; Electrical Ratings</b>													
Capacity	Cooling	24,400 (9,500-24,400)		31,200 (9,500-31,200)		39,000 (9,500-39,000)		24,400 (9,500-24,400)		31,200 (9,500-31,200)		39,000 (9,500-39,000)	
	Heating	---		---		---		30,800 (8,000-30,800)		37,400 (8,000-37,400)		44,500 (8,000-44,500)	
Moisture Removal	High	7.7		10.0		12.6		7.7		10.0		12.6	
Dry Air Flow	Hi / Med / Low	550 / 490 / 460		1,100 / 930 / 750		1,130 / 950 / 775		550 / 490 / 460		1,100 / 930 / 750		1,130 / 950 / 775	
SEER	Cooling	14.5		15.1		15.6		14.5		15.1		15.6	
EER	Cooling	8.5		8.10		9.4		8.5		8.10		9.4	
HSPF	Heating	---		---		---		9.4		8.8		9.5	
Power Supply	V, Phase, Hz	230 / 208 / 1 / 60		230 / 208 / 1 / 60		230 / 208 / 1 / 60		230 / 208 / 1 / 60		230 / 208 / 1 / 60		230 / 208 / 1 / 60	
Running Amps	Cooling	15.6 / 17.3		18.2 / 20.1		21.1 / 23.3		15.6 / 17.3		18.2 / 20.1		21.1 / 23.3	
	Heating	---		---		---		16.4 / 18.1		15.6 / 17.3		18.6 / 20.6	
Power Input	Cooling	2,880 / 2,880		3,840 / 3,840		4,140 / 4,140		2,880 / 2,880		3,840 / 3,840		4,140 / 4,140	
	Heating	---		---		---		3,000 / 3,000		3,250 / 3,250		3,630 / 3,630	
Fuse or Circuit Breaker Capacity	A	15	30	15	35	15	40	15	30	15	35	40	
<b>Features</b>													
Controls	Microprocessor		Microprocessor		Microprocessor		Microprocessor		Microprocessor		Microprocessor		
Low Ambient Control (for Cooling)	Built-in 0°F		Built-in 0°F		Built-in 0°F		Built-in 0°F		Built-in 0°F		Built-in 0°F		
Wireless Remote Controller (optional)	CZ-RWSU2U, CZ-RWSC1U		CZ-RWSU2U, CZ-RWSC1U		CZ-RWSU2U, CZ-RWSC1U		CZ-RWSU2U, CZ-RWSC1U		CZ-RWSU2U, CZ-RWSC1U		CZ-RWSU2U, CZ-RWSC1U		
Wired Remote Controller (included)	CZ-RTC2		CZ-RTC2		CZ-RTC2		CZ-RTC2		CZ-RTC2		CZ-RTC2		
Fan Speeds	3 and Automatic Control / Variable		3 and Automatic Control / Variable		3 and Automatic Control / Variable		3 and Automatic Control / Variable		3 and Automatic Control / Variable		3 and Automatic Control / Variable		
Timer	7 Days/6 Events		7 Days/6 Events		7 Days/6 Events		7 Days/6 Events		7 Days/6 Events		7 Days/6 Events		
Air Deflection	Horizontal	---		---		---		---		---		---	
	Vertical	Automatic		Automatic		Automatic		Automatic		Automatic		Automatic	
Air Filter	Washable		Washable		Washable		Washable		Washable		Washable		
Refrigerant	R-410A		R-410A		R-410A		R-410A		R-410A		R-410A		
Refrigerant control	Electric Expansion Valve		Electric Expansion Valve		Electric Expansion Valve		Electric Expansion Valve		Electric Expansion Valve		Electric Expansion Valve		
Operation Sound	In(Hi / Me / Lo)	39 / 37 / 33		42 / 40 / 35		44 / 41 / 37		39 / 37 / 33		42 / 40 / 35		44 / 41 / 37	
	Outdoor(Hi)	49		52		53		49		52		53	
Refrigerant Piping	Type	Flare		Flare		Flare		Flare		Flare		Flare	
	Discharge	3/8"		3/8"		3/8"		3/8"		3/8"		3/8"	
	Suction	5/8"		5/8"		5/8"		5/8"		5/8"		5/8"	
Refrigerant Pipe Length	FL	Max. 165		Max. 165		Max. 165		Max. 165		Max. 165		Max. 165	
Elevation Difference*	Outdoor Above	FL Max. 100		FL Max. 100		FL Max. 100		FL Max. 100		FL Max. 100		FL Max. 100	
	Outdoor Below	FL Max. 50		FL Max. 50		FL Max. 50		FL Max. 50		FL Max. 50		FL Max. 50	
<b>Dimensions &amp; Weight</b>													
Height	Indoor Unit	7-17/32"		9-7/16"		9-7/16"		7-17/32"		9-7/16"		9-7/16"	
	Outdoor Unit	30-23/32"		30-23/32"		48-7/16"		30-23/32"		30-23/32"		48-7/16"	
	Indoor Unit	37"		62-1/32"		37"		37"		62-1/32"		37"	
Width	Indoor Unit	51-3/16"		62-1/32"		37"		51-3/16"		62-1/32"		37"	
	Outdoor Unit	13-3/8"		26-3/8"		13-3/8"		13-3/8"		26-3/8"		13-3/8"	
Depth	Indoor Unit	26-3/8"		26-3/8"		13-3/8"		26-3/8"		26-3/8"		13-3/8"	
	Outdoor Unit	57.0		128.0		84.0		57.0		128.0		84.0	
Net Weight	Indoor Unit	128.0		143.0		220.0		128.0		143.0		220.0	
	Outdoor Unit	84.0		143.0		220.0		84.0		143.0		220.0	

\* This is maximum elevation difference when the indoor unit is located above the outdoor unit. (Refer to the table on the back of the catalog)



# Ceiling-Recessed Air Conditioners and Heat Pumps

KS12NB41 / KS18NB4U

KE12NB41 / KE18NB4U

**Indoor Unit**  
CS-KS12NB41  
CS-KS18NB4UW  
CS-KE12NB41  
CS-KE18NB4UW  
**Grille Assembly**  
CZ-18BT1U



Wireless Remote Controller (Included)

Wired Remote Controller (optional)



**Outdoor Unit**  
CU-KS12NK1A  
CU-KE12NK1



**Outdoor Unit**  
CU-KS18NKUA  
CU-KE18NKU



26PSU1U6

26PEU1U6

**Indoor Unit**  
S-26PU1U6  
**Grille Assembly**  
CZ-24KPU1U



Wired Remote Controller (Included)

36PSU1U6 / 42PSU1U6

36PEU1U6 / 42PEU1U6

**Indoor Unit**  
S-36PU1U6 / S-42PU1U6  
**Grille Assembly**  
CZ-36KPU1U



Wired Remote Controller (Included)

**Outdoor Unit**  
U-26PS1U6  
U-26PE1U6

**Outdoor Unit**  
U-36PS1U6  
U-36PE1U6

**Outdoor Unit**  
U-42PS1U6  
U-42PE1U6



## 4-Way Airflow Design Sends Cool Air in all Directions

Air is returned through the center of the grille, while evenly distributing air through each of the 4 supply air openings. Installation in the center of the room provides for the greatest comfort. However, 1 or 2 supply louvers can be closed for installation near 1 wall to provide 3 or 2 way airflow. Also, by closing off 1 supply louver, you may attach a duct (field supply) to the upper plenum and provide conditioned air to another, separate area.

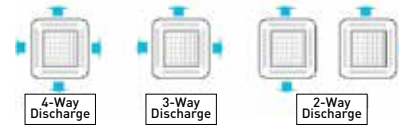

## Integrated Drain Pump

Drain pump is built into the unit to raise the condensate up 20 inches from the drain pump discharge.

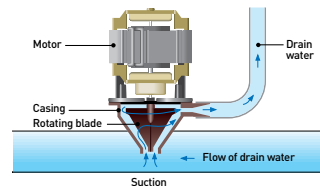

## Fresh Air Intake Plenum (Option)

When used to take in fresh air, attach the fresh air-intake plenum to the unit. Air-intake plenum is optionally supplied. CZ-26BCU1U for S-26PU1U6 CZ-42BCU1U for S-36/42PU1U6



## Whisper-Quiet Operation

Thanks to the newly developed turbo fan and decreased resistance of the air path, one of the industry's lowest levels of noise has been achieved.

Model No.	Ceiling - Recessed				Air Conditioners				Heat Pumps				
	KS12NB41A		KS18NB4UA		KE12NB41		KE18NB4U						
Unit Model No.	Indoor Unit	Outdoor Unit	Indoor Unit	Outdoor Unit	Indoor Unit	Outdoor Unit	Indoor Unit	Outdoor Unit	Indoor Unit	Outdoor Unit	Indoor Unit	Outdoor Unit	
	CS-KS12NB41	CU-KS12NK1A	CS-KS18NB4UW	CU-KS18NKUA	CS-KE12NB41	CU-KE12NK1	CS-KE18NB4UW	CU-KE18NKU	CS-KE12NB41	CU-KE12NK1	CS-KE18NB4UW	CU-KE18NKU	
<b>Grille Assembly</b>	CZ-18BT1U				CZ-18BT1U				CZ-18BT1U				
<b>Performance &amp; Electrical Ratings</b>													
Capacity	Cooling Btu/h	11,900 (3,000 - 11,900)		17,500 (4,000 - 17,500)		11,900 (3,000 - 11,900)		17,500 (4,000 - 17,500)		11,900 (3,000 - 11,900)		17,500 (4,000 - 17,500)	
	Heating Btu/h	---		---		13,600 (3,000 - 13,600)		20,400 (4,400 - 20,400)		13,600 (3,000 - 13,600)		20,400 (4,400 - 20,400)	
Moisture Removal	High Pints/H	4.26		4.89		4.26		4.89		4.26		4.89	
Dry Air Flow	Hi / Med / Low CFM	235 / 206 / 194		341 / 294 / 253		235 / 206 / 194		341 / 294 / 253		235 / 206 / 194		341 / 294 / 253	
SEER	Cooling Btu/Wh	16		16		16		16		16		16	
EER	Cooling Btu/Wh	9.4		9.41		9.4		9.4		9.4		9.4	
HSPF	Heating Btu/Wh	---		---		8.5		8.5		8.5		8.5	
Power Supply	V, Phase, Hz	115V, Single phase, 60Hz		208 / 230V, Single phase, 60Hz		115V, Single phase, 60Hz		208 / 230V, Single phase, 60Hz		115V, Single phase, 60Hz		208 / 230V, Single phase, 60Hz	
Running Amps	Cooling A	12.6 (2.5-12.6)		8.3 (1.2-8.3)		12.6 (2.5-12.6)		8.3 (1.2-8.3)		12.6 (2.5-12.6)		8.3 (1.2-8.3)	
	Heating A	---		---		14.6 (2.5-14.6)		10.5 (1.3-10.5)		14.6 (2.5-14.6)		10.5 (1.3-10.5)	
Power Input	Cooling W	1,260 (250-1,260)		1,860 (250-1,860)		1,260 (250-1,260)		1,860 (250-1,860)		1,260 (250-1,260)		1,860 (250-1,860)	
	Heating W	---		---		1,460 (250-1,460)		2,340 (270-2,340)		1,460 (250-1,460)		2,340 (270-2,340)	
Fuse or Circuit Breaker Capacity	A	20		20		20		20		20		20	
<b>Features</b>													
Controls	Microprocessor			Microprocessor			Microprocessor			Microprocessor			
Low Ambient Control (for Cooling)	Equipped			Equipped			Equipped			Equipped			
Wireless Remote Controller	Included			Included			Included			Included			
Wired Remote Controller (optional)	CZ-R0515U			CZ-R0515U			CZ-R0515U			CZ-R0515U			
Fan Speeds	Hi/Me/Lo & Auto			Hi/Me/Lo & Auto			Hi/Me/Lo & Auto			Hi/Me/Lo & Auto			
Timer	1 hr OFF and 24-hr PROGRAM			1 hr OFF and 24-hr PROGRAM			1 hr OFF and 24-hr PROGRAM			1 hr OFF and 24-hr PROGRAM			
Air Deflection	Horizontal	---			---			---			---		
	Vertical	---			---			---			---		
Air Filter	Automatic Washable			Automatic Washable			Automatic Washable			Automatic Washable			
Refrigerant	R-410A			R-410A			R-410A			R-410A			
Refrigerant Control	Electric Expansion Valve			Electric Expansion Valve			Electric Expansion Valve			Electric Expansion Valve			
Operation Sound	In(Hi / Me / Lo) dB-A	34 / 32 / 31		44 / 40 / 36		34 / 32 / 31		44 / 40 / 36		34 / 32 / 31		44 / 40 / 36	
	Outdoor(Hi) dB-A	47		47		51		51		47		47	
Refrigerant Piping (Cooling)	Type	Flare		Flare		Flare		Flare		Flare		Flare	
	Discharge inches	1/4"		1/4"		1/4"		1/4"		1/4"		1/4"	
	Suction inches	3/8"		1/2"		3/8"		1/2"		3/8"		1/2"	
Refrigerant Pipe Length	Fl.	65		98		65		98		65		98	
Elevation Difference*	Outdoor Above Ft.	23		50		23		50		23		50	
	Outdoor Below Ft.	23		50		23		50		23		50	
<b>Dimensions &amp; Weight</b>													
Height	inches	12-5/16"	21-9/16"	12-5/16"	26-3/8"	12-5/16"	21-9/16"	12-5/16"	26-3/8"	12-5/16"	21-9/16"	12-5/16"	26-3/8"
Width	inches	24-19/32"	28-11/32"	24-19/32"	34-21/32"	24-19/32"	28-11/32"	24-19/32"	34-21/32"	24-19/32"	28-11/32"	24-19/32"	34-21/32"
Depth	inches	24-19/32"	10-7/16"	24-19/32"	11-7/32"	24-19/32"	10-7/16"	24-19/32"	11-7/32"	24-19/32"	10-7/16"	24-19/32"	11-7/32"
Net Weight	Lbs.	41.3	75.0	41.3	90.4	41.3	75.0	41.3	90.4	41.3	75.0	41.3	97.0

Model No.	Ceiling - Recessed				Air Conditioners				Heat Pumps				
	26PSU1U6		36PSU1U6		42PSU1U6		26PEU1U6		36PEU1U6		42PEU1U6		
Unit Model No.	Indoor Unit	Outdoor Unit	Indoor Unit	Outdoor Unit	Indoor Unit	Outdoor Unit	Indoor Unit	Outdoor Unit	Indoor Unit	Outdoor Unit	Indoor Unit	Outdoor Unit	
	S-26PU1U6	U-26PS1U6	S-36PU1U6	U-36PS1U6	S-42PU1U6	U-42PS1U6	S-26PU1U6	U-26PE1U6	S-36PU1U6	U-36PE1U6	S-42PU1U6	U-42PE1U6	
<b>Grille Assembly</b>	CZ-24KPU1U				CZ-36KPU1U				CZ-36KPU1U				
<b>Performance &amp; Electrical Ratings</b>													
Capacity	Cooling Btu/h	24,800 (9,500 - 24,800)		32,600 (9,500 - 32,600)		39,500 (9,500 - 39,500)		24,800 (9,500 - 24,800)		32,600 (9,500 - 32,600)		39,500 (9,500 - 39,500)	
	Heating Btu/h	---		---		---		29,800 (8,000 - 29,800)		37,600 (8,000 - 37,600)		48,000 (8,000 - 48,000)	
Moisture Removal	High Pints/H	8.1		10.6		12.6		8.1		10.6		12.6	
Dry Air Flow	Hi / Med / Low CFM	710 / 530 / 450		1,050 / 840 / 720		1,050 / 840 / 720		710 / 530 / 450		1,050 / 840 / 720		1,050 / 840 / 720	
SEER	Cooling	14.1		14.6		14.6		14.1		14.6		14.6	
EER	Cooling	8.5		8.1		8.7		8.5		8.1		8.7	
HSPF	Heating	---		---		---		9.6		8.4		9.7	
Power Supply	V, Phase, Hz	230 / 208 / 11 / 60		230 / 208 / 1 / 60		230 / 208 / 1 / 60		230 / 208 / 1 / 60		230 / 208 / 1 / 60		230 / 208 / 1 / 60	
Running Amps	Cooling A	15.6 / 17.3		18.7 / 20.7		23.0 / 25.4		15.6 / 17.3		18.7 / 20.7		23.0 / 25.4	
	Heating A	---		---		---		14.8 / 16.4		15.9 / 17.6		22.4 / 24.8	
Power Input	Cooling W	2,920 / 2,920		3,950 / 3,950		4,520 / 4,520		2,920 / 2,920		3,950 / 3,950		4,520 / 4,520	
	Heating W	---		---		---		2,790 / 2,790		3,350 / 3,350		4,360 / 4,360	
Fuse or Circuit Breaker Capacity	A	15	30	15	35	15	40	15	30	15	35	15	40
<b>Features</b>													
Controls	Microprocessor			Microprocessor			Microprocessor			Microprocessor			
Low Ambient Control (for Cooling)	Built-in 0°F			Built-in 0°F			Built-in 0°F			Built-in 0°F			
Wireless Remote Controller (optional)	CZ-RWSU2U, CZ-RWSC1U			CZ-RWSU2U, CZ-RWSC1U			CZ-RWSU2U, CZ-RWSC1U			CZ-RWSU2U, CZ-RWSC1U			
Wired Remote Controller (included)	CZ-RTC2			CZ-RTC2			CZ-RTC2			CZ-RTC2			
Fan Speeds	3 and Automatic Control / Variable			3 and Automatic Control / Variable			3 and Automatic Control / Variable			3 and Automatic Control / Variable			
Timer	7 Days/6 Events			7 Days/6 Events			7 Days/6 Events			7 Days/6 Events			
Air Deflection	Horizontal	---			---			---			---		
	Vertical	Automatic			Automatic			Automatic			Automatic		
Air Filter	Washable			Washable			Washable			Washable			
Refrigerant	R-410A			R-410A			R-410A			R-410A			
Refrigerant Control	Electric Expansion Valve			Electric Expansion Valve			Electric Expansion Valve			Electric Expansion Valve			
Operation Sound	In(Hi / Me / Lo) dB-A	38 / 35 / 31		44 / 37 / 33		45 / 38 / 34		38 / 35 / 31		44 / 37 / 33		45 / 38 / 34	
	Outdoor(Hi) dB-A	49		52		53		49		52		53	
Refrigerant Piping	Type	Flare		Flare		Flare		Flare		Flare		Flare	
	Discharge inches	3/8"		3/8"		3/8"		3/8"		3/8"		3/8"	
	Suction inches	5/8"		5/8"		5/8"		5/8"		5/8"		5/8"	
Refrigerant Pipe Length	Fl.	Max. 165		Max. 165		Max. 165		Max. 165		Max. 165		Max. 165	
Elevation Difference*	Outdoor Above Ft.	Max. 100		Max. 100		Max. 100		Max. 100		Max. 100		Max. 100	
	Outdoor Below Ft.	Max. 50		Max. 50		Max. 50		Max. 50		Max. 50		Max. 50	
<b>Dimensions &amp; Weight</b>													
Height	inches	13-5/16"	30-23/32"	14-31/64"	30-23/32"	14-31/64"	48-7/16"	13-5/16"	30-23/32"	14-31/64"	30-23/32"	14-31/64"	48-7/16"
Width	inches	33-55/64"	37"	45-9/32"	37"	45-9/32"	37"	33-55/64"	37"	45-9/32"	37"	45-9/32"	
Depth	inches	33-55/64"	13-3/8"	33-55/64"	13-3/8"	33-55/64"	13-3/8"	33-55/64"	13-3/8"	33-55/64"	13-3/8"	33-55/64"	
Net Weight	Lbs.	49.0	128.0	60.0	143.0	60.0	220.0	49.0	128.0	60.0	143.0	60.0	220.0

\* This is maximum elevation difference when the indoor unit is located above the outdoor unit. (Refer to the table on the back of the catalog for more detail.)

# Concealed Duct Air Conditioners and Heat Pumps

# Optional Accessories

**26PSF1U6** **26PEF1U6**

**Indoor Unit**  
**S-26PF1U6**  
Supplies are 8" dia



**Outdoor Unit**  
**U-26PS1U6**  
**U-26PE1U6**

Wired Remote Controller (Included)



**36PSF1U6** **36PEF1U6**

**Indoor Unit**  
**S-36PF1U6**  
Supplies are 8" dia



**Outdoor Unit**  
**U-36PS1U6**  
**U-36PE1U6**

Wired Remote Controller (Included)



Outline diagram with medium or high-performance filter field installed.

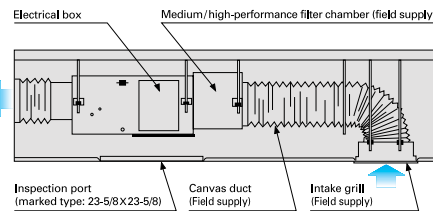

**Built-In Drain Pump**

Drain pump is built into the unit to raise the condensate up 20 inches from the drain pump discharge.

**Installation Example**

The picture shows the standard ducting system, where air is taken in from the back of the unit. This system is useful for places that need extensive air conditioning, including conference halls, showrooms, and restaurants.



		Concealed Duct							
		Air Conditioners				Heat Pumps			
Model No.	Unit Model No.	26PSF1U6		36PSF1U6		26PEF1U6		36PEF1U6	
		Indoor Unit	Outdoor Unit	Indoor Unit	Outdoor Unit	Indoor Unit	Outdoor Unit	Indoor Unit	Outdoor Unit
		S-26PF1U6	U-26PS1U6	S-36PF1U6	U-36PS1U6	S-26PEF1U6	U-26PE1U6	S-36PEF1U6	U-36PE1U6
<b>Performance &amp; Electrical Ratings</b>									
Capacity	Cooling	8tu/h 24,000 (9,500 - 24,000)		31,200 (9,500 - 31,200)		24,000 (9,500 - 24,000)		31,200 (9,500 - 31,200)	
	Heating	---		---		28,600 (8,000 - 28,600)		36,200 (8,000 - 36,200)	
Moisture Removal	High	7.7		10.0		7.7		10.0	
	Dry Air Flow	Hi / Med / Low 670 / 530 / 460 CFM		1,060 / 920 / 750		670 / 530 / 460		1,060 / 920 / 750	
SEER	Cooling	14.0		13.9		14.0		13.9	
	EER	9.1		7.8		9.1		7.8	
HSPF	Heating	---		---		9.0		8.5	
	Power Supply	V, Phase, Hz 230 / 208, 1Ph, 60Hz		230 / 208, 1Ph, 60Hz		230 / 208, 1Ph, 60Hz		230 / 208, 1Ph, 60Hz	
Running Amps	Cooling	A 13.6 / 15.0		18.6 / 20.6		13.6 / 15.0		18.6 / 20.6	
	Heating	---		---		12.5 / 13.8		15.9 / 17.6	
Power Input	Cooling	W 2,600 / 2,600		3,920 / 3,920		2,600 / 2,600		3,920 / 3,920	
	Heating	---		---		2,400 / 2,400		3,340 / 3,340	
External Static Pressure	in. WC	0.20		0.24		0.20		0.24	
Fuse or Circuit Breaker Capacity	A	15	30	15	35	15	30	15	35
<b>Features</b>									
Controls		Microprocessor							
Low Ambient Control		Built-in 0°F							
Wireless Remote Controller (optional)		CZ-RWSU2U, CZ-RWSC1U		CZ-RWSU2U, CZ-RWSC1U		CZ-RWSU2U, CZ-RWSC1U		CZ-RWSU2U, CZ-RWSC1U	
Wired Remote Controller (included)		CZ-RTC2							
Fan Speeds		3 and Automatic Control / Variable							
Timer		7 Days/6 Events							
Air Deflection	Horizontal	---							
	Vertical	---							
Air Filter		---							
Refrigerant Control		Electric Expansion Valve							
Operation Sound	In(Hi / Me / Lo)	dB-A 34 / 30 / 27		38 / 30 / 27		34 / 30 / 27		38 / 30 / 31	
	Outdoor(Hi)	49		52		49		52	
Refrigerant Piping	Type	Flare							
	Discharge	inches 3/8"		3/8"		3/8"		3/8"	
	Suction	inches 5/8"		5/8"		5/8"		5/8"	
Refrigerant Pipe Length	Ft.	Max. 165		Max. 165		Max. 165		Max. 165	
Elevation Difference**	Outdoor Above	Ft. Max. 100		Max. 100		Max. 100		Max. 100	
	Outdoor Below	Ft. Max. 50		Max. 50		Max. 50		Max. 50	
<b>Dimensions &amp; Weight</b>									
Height	inches	12-7/32"		30-23/32"		12-7/32"		30-23/32"	
	inches	39-3/8"		37"		39-3/8"		37"	
Width	inches	24-13/16"		13-3/8"		24-13/16"		13-3/8"	
	inches	71.0		128.0		104.0		143.0	
Depth	inches	12.0		14.0		12.0		14.0	
	Lbs.	71.0		128.0		104.0		143.0	

\*\* This is maximum elevation difference when the indoor unit is located above the outdoor unit. (Refer to the table on the back of the catalog for more detail.)

**Condensate Pump**  
SI-30-120  
SI-30-240  
SI1730-2



**Tube Size Adapter**  
CZ-MA1P  
CZ-MA2P  
CZ-MA3P



**Locking Bracket for Remote Control**  
RCS5PS4B  
RCS4MHVB  
RCPTC110B



**Wired Remote Controller**  
**CZ-RD516C-1**



**Timer Remote Controller**  
**CZ-RTC2**

**Replacement Anti-microbial Filter**  
CZ-SA20P



**Fresh Air Intake Plenum**  
CZ-26BCU1U  
CZ-42BCU1U



**Wired Remote**  
**CZ-RD515U**



**System Controller**  
**CZ-64ESMC1U**

H.V.A.C. Accessories		
Model No.	Description	Use With
DL04060815	Insulated Tubing Kit 1/4" x 3/8" x 1/2" x 15'	S9NKU-1, S12NKU-1, S9NKUA, S12NKUA, KS12NB41A, E9NKUA, E12NKUA, KE12NB41, CU-2S18NB4U, CU-2E18NBKU, CU-3KS19NBU, CU-4KS24NBU, CU-4KS31NBU, CU-3KE19NBU, CU-4KE24NBU, CU-4KE31NBU, CS-MKS7NKU, CS-MKS9NKU, CS-MKS12NKU, CS-MKE7NKU, CS-MKE9NKU, CS-MKE12NKU
DL04060820	Insulated Tubing Kit 1/4" x 3/8" x 1/2" x 20'	
DL04060835	Insulated Tubing Kit 1/4" x 3/8" x 1/2" x 35'	
DL04080815	Insulated Tubing Kit 1/4" x 1/2" x 1/2" x 15'	
DL04080820	Insulated Tubing Kit 1/4" x 1/2" x 1/2" x 20'	S18NKU-1, KS18NB4U, S18NKUA, KS18NB4UA, E18NKUA, KE18NKU, KE18NB4U, CU-3KS19NBU, CU-4KS24NBU, CU-4KS31NBU, CU-3KE19NBU, CU-4KE24NBU, CU-4KE31NBU, CS-MKS18NKU, CS-MKE18NKU, S12NKU-1, S12NKUA
DL04100820	Insulated Tubing Kit 1/4" x 5/8" x 1/2" x 20'	
DL04100830	Insulated Tubing Kit 1/4" x 5/8" x 1/2" x 30'	
DL04100850	Insulated Tubing Kit 1/4" x 5/8" x 1/2" x 50'	KS24NKUA, KE24NKU, CU-4KS24NBU, CU-4KS31NBU, CU-4KE24NBU, CU-4KE31NBU, CS-MKS24NKU, CS-MKE24NKU
DL06100830	Insulated Tubing Kit 3/8" x 5/8" x 1/2" x 30'	All 26,000 Through 42,000 BTU/h Models
DL06100850	Insulated Tubing Kit 3/8" x 5/8" x 1/2" x 50'	All 26,000 Through 42,000 BTU/h Models
CZ-26BCU1U	Fresh Air Intake Plenum	S-26PU1U6
CZ-42BCU1U	Fresh Air Intake Plenum	S-36PU1U6, S-42PU1U6
RCS5PS4B	Locking Bracket for Remote Controller	All 26,000 Through 42,000 BTU/h Models except 30 & 36
RCS4MHVB	Locking Bracket for Wireless Remote Controller	All KS, KE, MKS & MKE Models
RCPTC110B	Locking Bracket for Wireless Remote Controller	All S/E9, 12, 18, 22, 24 Models
BS600	Mounting Bracket for Outdoor Unit	CU-XE9PKUA, CU-XE12PKUA, CU-S9NKU-1, CU-S12NKU-1, CU-S18NKU-1, CU-S22NKU-1, CU-S26NKU-1, CU-S9NKUA, CU-S12NKUA, CU-S18NKUA, CU-S24NKUA, CU-KS30NKUA, CU-KS36NKUA, CU-KS12NK1A, CU-KS18NKUA, U-26PS1U6, U-36PS1U6, U-42PS1U6, CU-E9NKUA, CU-E12NKUA, CU-E18NKUA, CU-E24NKUA, CU-KE30NKU, CU-KE36NKU, CU-KE12NK1, CU-KE18NKU, U-26PE1U6, U-36PE1U6, U-42PE1U6, CU-2S18NB4U-1, CU-3KS19NBU, CU-4KS24NBU, CU-4KS31NBU, CU-2E18NB4U, CU-3KE19NBU, CU-4KE24NBU, CU-4KE31NBU
SI-30-120	Condensate Pump	All 115 volt Models
SI-30-240	Condensate Pump	All 230 volt Models (up to 2 ton)
SI1730-2	Condensate Pump	All 230 volt Models (High Vol. Condensate Removal) (2 ton and higher)
CZ-RE2C2	Simple Wired Remote	All 26,000 Through 42,000 BTU/h Models
CZ-RELC2	Simple Wired Remote with Backlight	All 26,000 Through 42,000 BTU/h Models
CZ-RD515U	Wired Remote Controller	All KS, KE, MKS & MKE Models
CZ-RD516C-1	Wired Remote Controller	XE9PKUA, XE12PKUA, S9NKUA, S12NKUA, S18NKUA, S24NKUA, E9NKUA, E12NKUA, E18NKUA, E24NKUA
CZ-RC515U	Wire Kit	PCB Wire Kit for CZ-RD515U - Required For Use With All KS&KE Models except 30 / 36
CZ-RC515UA	Wire Kit	PCB Wire Kit for CZ-RD515U, CS-KS30NKU, CS-KS36NKU, CS-KE30NKU, CS-KE36NKU
CZ-RTC2	Wired Timer Remote Controller	All 26,000 Through 42,000 BTU/h Models except 30 & 36
CZ-RWSK1U	Wireless Remote Controller	S-26PK1U6 / S-26PF1U6
CZ-RWSU2U	Wireless Remote Controller	S-26/36/42PT1U6, S-26/36/42PU1U6
CZ-RWSC1U	Wireless Remote Controller	S-26/36PF1U6
CZ-64ESMC1U	System Controller	All 26,000 Through 42,000 BTU/h Models except 30 & 36
CZ-MA1P	Tube size Reducer	CS-S12NKUW-1, CS-E12NKUAW (for connection with CU-2S18NB4U-1 / CU-2E18NBKU)
CZ-SA20P	Replacement Anti-microbial Filter	CS-S9NKUA, S12NKUA, S9NKUW-1, S12NKUW-1, CS-S18NKU, CS-S22NKU, CS-S18NKU-1, CS-S22NKU-1, CS-E9NKUAW, CS-E12NKUAW, CS-E18NKUA, CS-E24NKUA
WINDB-1	Wind Baffle	All models



## Wired Remote Controllers (Except KE30/36NKU, KS30/36NKU)

### Simplified Remote Controller



CZ-RE2C2 CZ-REL2 (with Backlight)

#### Key Features (Simple Remote):

- Thin and Easy To Read
- Simple To Install and Use
- Can Be Adapted for Use On All 26,000 through 42,000 Btu/h Indoor Units.
- Mode
- Fan Speed Control
- Set Temperature
- On/Off
- Airflow Direction
- Perfectly Suited for Applications Where Simpler Functionality is Required (ie: Hotel Rooms, Nursing Homes, Offices)

### Timer Remote Controller



CZ-RTC2

#### Key Features (Standard Remote/7 Day Timer):

- Thin and Easy To Read
- Simple To Install and Use
- Can Be Adapted for Use On All Indoor Units
- Fan Speed Control
- Airflow Direction
- Operating Mode (Heating/Cooling/Auto/Dry/Fan)
- Vacation Mode for Continued Energy Efficiencies
- Full 7 Day Set-Back Functionality, With Up To 6 Time Periods/Day
- Full System Diagnostic Capability (Diagnostic History Provides Immediate View of System Past and Present.)

### System Controller



CZ-64ESMC1U



#### Multiple Zone Controllers.

The Air Conditioning Gateway. Panasonic's system and intelligent controls are the central nervous system of the conditioning system, the gateway to all data, temperature and system diagnostics and the heart and soul of conditioning.

#### Key Features (System Control):

- Controls Up To 64 Units Into 4 Individualized Zones
- Alarm and Operational Signal Output
- Single Access Points for All Connected Wired Remotes

## Wireless Remote Controllers

Wireless Remote Controller	Applicable Unit	U1-series (Ceiling Recessed Type) T1-series (Ceiling Suspended Type)	For All Large capacity series Indoor Units
		<b>Built-in type</b> <ul style="list-style-type: none"> <li>• Signal receiving unit can be installed in the outer panel of indoor unit.</li> <li>• Control panel can be installed in the inside indoor unit.</li> </ul>	<b>External type</b> <ul style="list-style-type: none"> <li>• Separate type signal receiving unit.</li> </ul>
			

## Remote Controllers Functions

Function	Timer Remote Controller (CZ-RTC2)		System Controller (CZ-64ESMC1U)	
	● (Collective/Individual)	● (Individual)	● (Collective/Individual)	● (Individual)
ON/OFF	●	●	●	●
Operation mode switch	Heating	●	●	●
	Dry	●	●	●
	Cooling	●	●	●
	Fan	●	●	●
Temp setting	●	●	●	●
Fan speed setting (Hi/Mid./Lo/Auto)	●	●	●	●
Auto flap	●	●	●	●
Auto airflow direction setting	Auto airflow direction setting	●	●	●
	Arbitrary airflow direction setting	●	●	●
Sweep (Flap swing)	●	●	●	●
Sensor temp. display	●	●	●	×
Self-diagnostic function	●	●	●	●
Central control (at hand inhibited)	×	×	●	●
System	● (Up to 8 units)		● (Up to 64 groups)	
Group control	● (Up to 8 units)		● (Up to 64 groups)	
Concurrent use with weekly timer	●	●	●	●
Setting Range	Cooling, dry	(°F) 65 - 86	Heating	(°F) 61 - 79

**Note:**  
If you use both remote controller and system controller concurrently, both controllers can be used on a last-signal priority basis.

## 9,000 - 24,000 Btu/h single zone, KS30/36 NKUA, KE30/36NKU

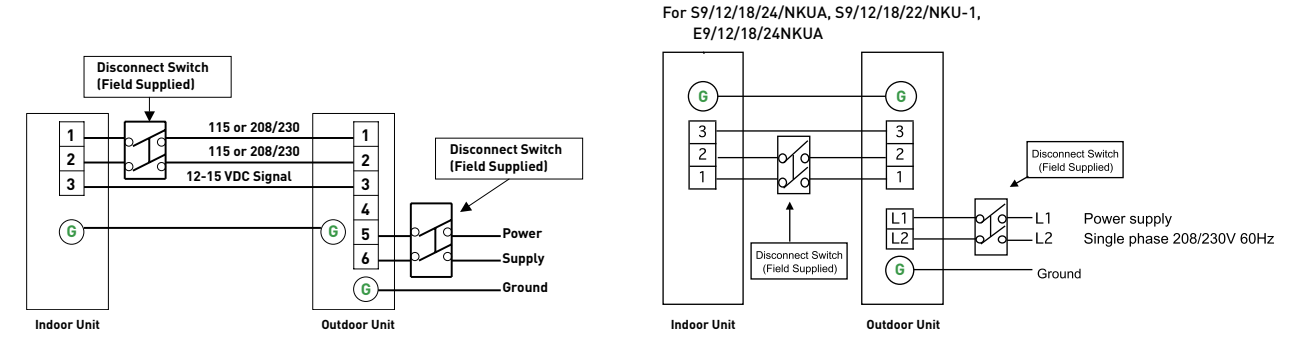

## 26,000 - 42,000 Btu/h single zone wiring schematic (Except KS30/36NKUA, KE30/36NKU)

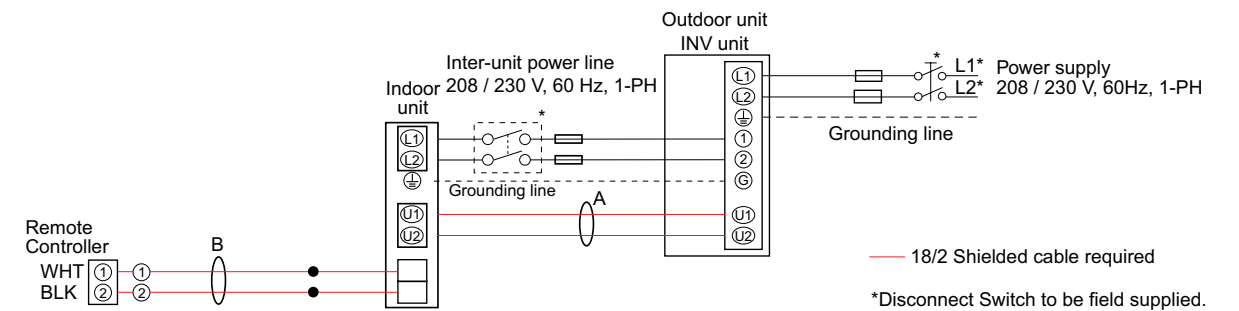

## RAC Multi wiring schematic

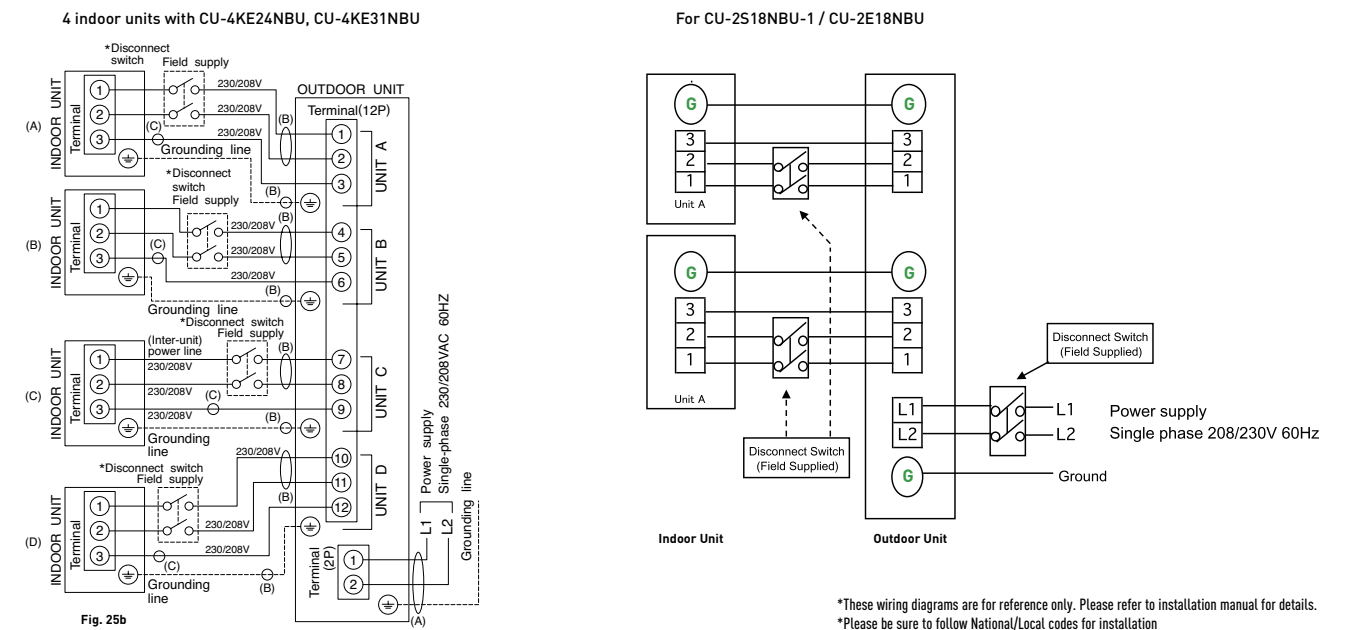

\*These wiring diagrams are for reference only. Please refer to installation manual for details.  
\*Please be sure to follow National/Local codes for installation

### Cooling Models (S9/12/18/22NKU-1)

	Temperature	Indoor Air Intake Temp.	Outdoor Air Intake Temp.
Cooling	Maximum	90°F DB / 74°F WB	115°F DB
	Minimum	60°F DB / 52°F WB	60°F DB / 52°F WB

### Low Ambient Cooling Models (S9/12/18/24NKUA)

	Temperature	Indoor Air Intake Temp.	Outdoor Air Intake Temp.
Cooling	Maximum	90°F DB / 74°F WB	115°F DB
	Minimum	60°F DB / 52°F WB	0°F DB(S18/24) / 5°F DB (S9/12)

### Cooling Models above 26,000 Btu

	Temperature	Indoor Air Intake Temp.	Outdoor Air Intake Temp.
Cooling	Maximum	95°F DB / 71°F WB	115°F DB
	Minimum	67°F DB / 57°F WB	0°F DB

### Cooling Models KS30/36NKUA

	Temperature	Indoor Air Intake Temp.	Outdoor Air Intake Temp.
Cooling	Maximum	95°F DB / 71°F WB	115°F DB
	Minimum	67°F DB / 57°F WB	0°F DB

### RAC Multi KS Series Cooling Models

	Temperature	Indoor Air Intake Temp.	Outdoor Air Intake Temp.
Cooling	Maximum	95°F DB / 71°F WB	115°F DB
	Minimum	67°F DB / 57°F WB	14°F DB

### RAC Multi KE Series Heating Models

	Temperature	Indoor Air Take	Outdoor Air Take
Cooling	Maximum	95°F DB / 71°F WB	115°F DB
	Minimum	67°F DB / 57°F WB	14°F WB
Heating	Maximum	80°F DB / 67°F WB	75°F DB / 65°F WB
	Minimum	60°F DB / -°F WB	0°F WB

### Heat Pump Models (XE9/12PKUA)

	Temperature	Indoor Air Intake Temp.	Outdoor Air Intake Temp.
Cooling	Maximum	90°F DB / 74°F WB	115°F DB / 79°F WB
	Minimum	60°F DB / 52°F WB	0°F DB / 0°F WB
Heating	Maximum	86°F DB / -°F WB	75°F DB / 64°F WB
	Minimum	60°F DB / -°F WB	0°F DB / -2 °F WB

### Heat Pump Models (E9/12/18/24NKUA)

	Temperature	Indoor Air Intake Temp.	Outdoor Air Intake Temp.
Cooling	Maximum	90°F DB / 74°F WB	115°F DB
	Minimum	60°F DB / 52°F WB	5°F DB(E18/24) / 5°F DB (E9/12)
Heating	Maximum	86°F DB / -°F WB	75°F DB / 64°F WB
	Minimum	60°F DB / -°F WB	5°F DB / -°F WB

### Heat Pump Models above 26,000 Btu

	Temperature	Indoor Air Intake Temp.	Outdoor Air Intake Temp.
Cooling	Maximum	95°F DB / 71°F WB	115°F DB
	Minimum	64°F DB / 57°F WB	0°F DB
Heating	Maximum	86°F DB / 67°F WB	75°F DB / 65°F WB
	Minimum	61°F DB / -°F WB	-4°F DB

### Heat Pump Models KE30/36NKU

	Temperature	Indoor Air Intake Temp.	Outdoor Air Intake Temp.
Cooling	Maximum	95°F DB / 71°F WB	115°F DB
	Minimum	67°F DB / 57°F WB	14°F DB
Heating	Maximum	80°F DB / 67°F WB	75°F DB / 65°F WB
	Minimum	60°F DB / -°F WB	0°F DB

## Sanyo to Panasonic Cross Reference

\* H/P: Heat Pump, C/O: Cooling Only

### PAC Outdoor 2types / 10models

Category	Capacity Kbtu/h	Model No.	Model No.	
PAC-i (Split)	H/P	26	CH2672R	U-26PE1U6
		36	CH3672R	U-36PE1U6
		42	CH4272R	U-42PE1U6
	C/O	30	CH3082	CU-KE30NKU
		36	CH3682	CU-KE36NKU
		36	C3682	CU-KE36NKUA

### PAC Indoor 5types / 15models (13models, Panel : 2models)

Category	Capacity Kbtu/h	Model No.	Model No.	
4-Way Cassette	H/P	26	XHW2672R	S-26PU1U6
		36	XHW3672R	S-36PU1U6
		42	XHW4272R	S-42PU1U6
	Panel	PNR-XH2442	CZ-24KP1U1	
		PNR-XH3642	CZ-36KP1U1	
		PNR-XH3642	CZ-36KP1U1	
Wall Mount	H/P	26	KHS2672R	S-26PK1U6
	C/O	26	KS3082	CS-KS30NKU
Wall Mount	H/P	30	KHS3082	CS-KS30NKU
		36	KHS3682	CS-KS36NKU
Ceiling Suspended	H/P	26	THW2672R	S-26PT1U6
		36	THW3672R	S-36PT1U6
Duct	H/P	26	UHW2672R	S-26PF1U6
		36	UHW3672R	S-36PF1U6

### RAC (37models)

Category	Capacity Kbtu/h	Model No.	Model No.
Mini Cassette	12	XS1271	CS-KS12NB41
	Panel	PNR-XS1872	CZ-18BT1U
Outdoor Unit	12	CL1271	CU-KS12NK1A
	18	C1872	CU-KS18NKU
	18	CL1872	CU-KS18NKUA
	24	C2472	CU-KS24NKU
	24	CL2472	CU-KS24NKUA
	Panel	PNR-XS1872	CZ-18BT1U
Mini Cassette	12	XHS1271	CS-KE12NB41
	18	XHS1872	CS-KE18NB4UW
Outdoor Unit	12	CH1271	CU-KE12NK1
	Panel	PNR-XS1872	CZ-18BT1U
Wall Mount	7	KMS0772	CS-MKS7NKU
	9	KMS0972	CS-MKS9NKU
	12	KMS1272	CS-MKS12NKU
	18	KMS1872	CS-MKS18NKU
	24	KMS2472	CS-MKS24NKU
	9	XMS0972	CS-MKS9NB4U
Mini Cassette	12	XMS1272	CS-MKS12NB4U
	Panel	PNR-XS1872	CZ-18BT1U
	19	CM1972A	CU-3KS19NBU
	24	CM2472A	CU-4KS24NBU
	31	CM3172A	CU-4KS31NBU
	7	KMHS0772	CS-MKE7NKU
Wall Mount	9	KMHS0972	CS-MKE9NKU
	12	KMHS1272	CS-MKE12NKU
	18	KMHS1872	CS-MKE18NKU
	24	KMHS2472	CS-MKE24NKU
	9	XMHS0972	CS-MKE9NB4U
	12	XMHS1272	CS-MKE12NB4U
Mini Cassette	12	PMH1272	CU-3KE12NB4U
	Panel	PNR-XS1872	CZ-18BT1U
Outdoor Unit	19	CMH1972A	CU-3KE19NBU
	24	CMH2472A	CU-4KE24NBU
	31	CMH3172A	CU-4KE31NBU

### Controllers

Category	Common	Model No.	Model No.
Wireless RC	4-Way	RCS-BH80AAB.WL	CZ-RWSC1U
	Wall Mount	RCS-SH80AAB.WL	CZ-RWSU1U
System Controller		SHA-KC64UG	CZ-64ESMC1U
Simple Remote		RCS-KR1EG	CZ-RE2C2
Simple Wired RC		NEW	CZ-RELC2
Wireless RC	U1/T1 Series	RCS-SH80UA.WL	CZ-RWSU2U
		STK-KCW1	CZ-RC515U
Wired Kit		STK-KCW2	CZ-RC515UA
Wired RC		STK-RCS-7TWSUA	CZ-RD515U

### Accessories

Category	Model No.	Model No.	
Fresh Air intake	4-Way	CMB-GSJ80U	CZ-26BCU1U
	4-Way	CMB-GSJ140U	CZ-42BCU1U
Outdoor Bracket		STK-KSB2050	CZ-12UD1U
		STK-KSB0500	CZ-30UD1U

## Rating Conditions

	Cooling	Heating
Inside air temperature	80°F DB / 67°F WB	70°F DB / 60°F WB
Outside air temperature	95°F DB (75°F WB)	47°F DB / 43°F WB

SYSTEM MODEL	OD Tube Size (Inches)		Maximum length (ft) of tubing between In/Outdoor	Maximum Elevation difference (ft) between In/Outdoor		Maximum Length(ft) of Tubing at shipment	Required Additional Refrigerant Oz/ft	Insulation									
	Narrow	Wide		Outdoor Above	Outdoor Below												
S9NKU-1	1/4"	3/8"	49'	16'	16'	25'	R-410A 0.2	Both Tubes									
S9NKUA			66'	49'	49'												
XE9PKUA				23'	23'												
E9NKUA			1/2"		5/8"				49'	16'	16'	33'	R-410A 0.2				
KS12NB41A				66'					49'	49'							
KE12NB41									100'	50'	50'			25'	R-410A 0.27		
S12NKU-1				66'						49'	49'				33'	R-410A 0.2	
S12NKUA									131'	49'	49'			33'		R-410A 0.2	
XE12PKUA				100'						50'	50'				25'	R-410A 0.27	
E12NKUA									66'	49'	49'			33'		R-410A 0.2	
S18NKU-1	131'	49'		49'		33'	R-410A 0.2										
S18NKUA		100'		50'			50'	25'	R-410A 0.3								
E18NKUA	3/8"			5/8"		66'	100'		50'	100'	R-410A 0.43						
KS18NKUA		66'	49'		49'	33'		R-410A 0.2									
KS18NB4UA			100'		50'			50'				25'	R-410A 0.3				
KE18NB4U		66'			49'	49'		33'					R-410A 0.2				
S22NKU-1			131'		49'	49'						33'	R-410A 0.2				
S24NKUA		100'			50'	50'		25'					R-410A 0.3				
E24NKUA			1/4"		3/8"	66'						82'	49'	65'	R-410A 0.2		
26PSK1U6		66'				49'		49'								33'	R-410A 0.2
26PST1U6						100'		50'									50'
26PSU1U6		66'						49'								49'	33'
26PSF1U6	131'			49'		49'	33'	R-410A 0.2									
26PEK1U6		100'		50'		50'		25'	R-410A 0.27								
26PET1U6	66'			49'		49'	33'		R-410A 0.2								
26PEU1U6		131'		49'		49'		33'	R-410A 0.2								
26PEF1U6	100'			50'		50'	25'		R-410A 0.27								
KS30NKUA		66'		49'		49'		33'	R-410A 0.2								
KE30NKU	100'		50'	50'	25'	R-410A 0.3											
KS36NKUA		66'	49'	49'		33'	R-410A 0.2										
KE36NKU	100'		50'	50'	25'		R-410A 0.3										
36PST1U6		66'	49'	49'		33'	R-410A 0.2										
36PSU1U6	131'		49'	49'	33'		R-410A 0.2										
36PSF1U6		100'	50'	50'		25'	R-410A 0.27										
36PET1U6	66'		49'	49'	33'		R-410A 0.2										
36PEU1U6		131'	49'	49'		33'	R-410A 0.2										
36PEF1U6	100'		50'	50'	25'		R-410A 0.27										
42PST1U6		66'	49'	49'		33'	R-410A 0.2										
42PSU1U6	131'		49'	49'	33'		R-410A 0.2										
42PET1U6		100'	50'	50'		25'	R-410A 0.27										
42PEU1U6	66'		49'	49'	33'		R-410A 0.2										
CU-2S18NBU-1		1/4"	3/8"	82'		82'	49'	65'	R-410A 0.2								
CU-2E18NBU	3/8"x3, 1/2"x1			50'	50'					150'	R-410A 0.22						
CU-3KS19NBU		3/8"x2, 1/2"x2	100'	82'	49'	65'	R-410A 0.2										
CU-3KE19NBU	3/8"		82'					82'	49'	65'	R-410A 0.2						
CU-4KS24NBU		3/8"	3/8"	82'	82'	49'	65'					R-410A 0.2					
CU-4KE24NBU	3/8"			3/8"				82'	82'	49'	65'		R-410A 0.2				
CU-4KS31NBU		3/8"	3/8"		82'	82'	49'	65'				R-410A 0.2					
CU-4KE31NBU	3/8"			3/8"	82'				82'	49'	65'		R-410A 0.2				
CU-5KE36QBU		3/8"	3/8"		82'	82'	49'	65'				R-410A 0.2					